

Accessibility Compliance Report For DA Application

Project Address: 160-172 Lord Sheffield Cir, Penrith NSW
Prepared For: Urban Property Group

Issue No: B
Issue Date: 02/11/2022
Report No: 22-105

Report Register:

The following report register documents the development and issue of this report as undertaken by Access Link Consulting Pty Ltd.

Report No.	Issue No.	Issue Date	Report Details
22-105	A	26/10/2022	DRAFT Issue
22-105	B	02/11/2022	Issue for DA

Yours Sincerely,



Rami Shakour
Director

Bachelor of Architecture Degree
Master of Project Management



Accredited Access Consultant – ACAA
(Association of Consultants in Access,
Australia, membership No. 488)



NDIS Accredited SDA Assessor
(Reg No: SDA00030)



Diploma of Access
Consulting



Livable Housing
Australia - LHA (Reg
No: 20157)



1.0 - Report Purpose:

This assessment has been undertaken to the necessary level to issue a DA “Development Application” under the environmental planning and assessment Act. based on the information provided.

The subject project achieves the spatial requirements to provide access for people with disability under the relevant standards and codes, it is required that a detailed assessment to be undertaken covering but not limited of internal fit-out, details for stairs, ramps, finishes, amenities and other features to occur at CC “Construction Certificate” stage.

By adopting the recommendation set in this report, compliance with the report basis will be achieved and equable and dignified access for all users of the building/facility will be provided.

2.0 – Project Description and Use:

The proposed project consists of a total of 287 residential units, 15 retail tenancies and 1 commercial tenancy above 3 levels of basement parking. A mix of units are provided as follow;

- One Bedroom Units – 58 Units
- Two Bedroom Units – 182 Units
- Three Bedroom Units – 47 Units

3.0 – Project Classification:

This accessibility compliance report for a proposed building with classification as set below:

- Class 2
- Class 5
- Class 6
- Class 7a

Note: The classification/s above is our understating of the relevant BCA classification/s. BCA consultant/certifier must confirm and determine the BCA classifications.

4.0 – Report Basis:

This report is based in the context of:

- National Construction Code, 2019 Amendment 1 Volume One – Building Code of Australia (BCA).
 - DP1, DP2, DP8, DP9
 - EP3.4
 - FP2.1
 - Parts of D2, D3, E3 and F2
- AS 1428.1 – 2009
- AS 1428.4.1 – 2009
- AS 2890.6 – 2009
- AS 4299 – 1995
- AS 1735.12 – 1999
- Disability (Access to Premises-Building) Amended Standards 2010
- Australian Human Rights Commission’s Guidelines on application of APS version 2.
- Livable Housing Australia’s Livable Housing Design Guidelines – Fourth Edition

5.0 – Assessed Drawings:

Drawing No.	Drawing Title	Issue	Issue Date
A-1000	Basement 03	8	01.11.2022
A-1001	Basement 02	12	01.11.2022
A-1002	Basement 01	11	01.11.2022
A-1003	Ground Level	14	01.11.2022
A-1003M	Ground Mezzanine	4	01.11.2022
A-1004	Level 1	15	01.11.2022
A-1005	Level 2	14	01.11.2022
A-1006	Level 3	14	01.11.2022
A-1007	Level 4-9	5	01.11.2022
A-1013	Communal Rooftop	9	01.11.2022
A-1014	Roof	12	01.11.2022
A-4410	Adaptable & Livable	4	01.11.2022

6.0 – Copyright

- 6.1 The contents of this report are copyright and prepared only for the attention of the client on this project. The rights to this report are owned by Access Link Consulting Pty Ltd.
- 6.2 The contents of this report contain Standard Australia Ltd copyrighted materials and must not be reproduced, sold, published, combined with external documents or altered without the prior written permission of its distributor, SAI Global Ltd and Access Link Consulting Pty Ltd.
- 6.3 This report may be reproduced in accordance with the terms of SAI Global Ltd License 1704-c045-2 to Access Link Consulting Pty Ltd.

7.0 – Exclusions and Liabilities

- 7.1 This Clause operates simultaneously with the terms set out in Access Link Consulting Pty Ltd.'s Fee Proposal/Cost Agreement.
- 7.2 Access Link Consulting Pty Ltd is only retained for the purpose of producing information relating to Access in the context of the codes, standards, regulations and guidelines listed in Clause 4.0 of this report. Access Link Consulting Pty Ltd is not liable for producing any other information outside this context.
- 7.3 The client acknowledges the following:
 - 7.3.1 This report is solely for the purpose of reviewing, identifying and advising on Access issues/Access related provisions of the BCA.
 - 7.3.2 This report does not identify or cover any information, compliance matters or issues that are related to other services associated to this project.
The client is aware that it is the architect's responsibility to coordinate and check all services against the information and requirements provided in this report to ensure that compliance has been met and achieved.
 - 7.3.3 This report does not identify or cover any information, compliance matters or issues in relation to the construction stage of this project.
The client is aware that it is the builder's responsibility to coordinate and check that all the information and requirements provided in this report are met and achieved during the construction stage of this project.
 - 7.3.4 This report does not identify or cover checks for:
 - a) Slip resistance in surfaces such as set areas, parking areas, common spaces or stairs; and/or,
 - b) Wall reinforcement once the walls have already been constructed.*The client is aware that it is the builder's responsibility to ensure that the requirements are met as per AS 1428.1, AS 4299, AS 2890, AS 3661, AS 4586 and any other relevant codes that may arise.*
 - 7.3.5 Our Report does not assess compliance matters related to the following:
 - a. Work, Health and Safety;
 - b. Structural design;
 - c. Service Design; and/or,
 - d. Parts of the Disability Discrimination Act other than those that relate to the APS, Parts of BCA or Parts of AS other than those directly referenced in our Report.

- 7.3.6 Access Link Consulting Pty Ltd does not guarantee or warrant that our Report is correct or complete and will not be liable for any losses arising from the reliance upon or use of our Report.
- 7.3.7 Should the Client engage services with another certifier or access consultant, we are not liable if that certifier or access consultant comes to a different conclusion in their report.
- 7.4 Access Link Consulting Pty Ltd is therefore not liable for any other services that are associated to this project.
- 7.5 Except as required by law, Access Link Consulting Pty Ltd is not liable for any inaccurate or incorrect information in this report supplied by SAI Global Ltd.
- 7.6 This document/report is based on the classification of this project and the drawings set out in Clause 6.0 of this report. In the event that changes are made to the classification or drawings, this report will be deemed invalid and will be required to be updated accordingly.

Yours Sincerely,

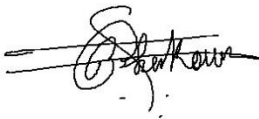
A handwritten signature in black ink, appearing to read 'Rami Shakour', with a horizontal line drawn through it.

Rami Shakour

Director



Checklist Assessment Related to the Requirements Set in the BCA

The extract clauses from the NCC, 2019 Amd. 1 Volume 1 – BCA below to be read in full format as set in the National Construction Code, 2019 Amd. 1 Volume 1 – Building Code of Australia.

Part D3 – Access For People With Disability

D3.1 General Building Access Requirements

ADR

N/A

C

Buildings and parts of buildings must be accessible:

Class 2

- I. From a pedestrian entrance required to be accessible to at least 1 floor containing sole-occupancy units.
- II. To the entrance doorway of each sole-occupancy unit located on that level.
- III. To and within each type of room or space for use in common by the residents.
- IV. Where a floor is accessed via an AS 1428.1 Ramp or passenger lift, all entrance doors to sole occupancy units and common spaces used by residents located on the levels served by the lift or ramp.

☐☐

✓

☐☐

✓

☐☐

✓

☐☐

✓

Reference: Figure 1, Figure 2, Figure 3, Figure 4

Notes: See Att. 01 – can be compliant at CC stage

Class 5

- To and within all areas normally used by the occupants

☐☐

✓

Reference: Figure 1, Figure 2, Figure 3, Figure 4

Notes: See Att. 01 – can be compliant at CC stage

Class 6

- To and within all areas normally used by the occupants

☐☐

✓

Reference: Figure 1, Figure 2, Figure 3, Figure 4

Notes: See Att. 01 – can be compliant at CC stage

Class 7a

- To and within any level containing accessible car parking spaces.

☐☐

✓

D3.2 Access To Buildings

ADR

N/A

C

(a) Access way must be provided to a building;

- I. From the main points of a pedestrian entry at the allotment boundary
- II. From another accessible building connected by a pedestrian link
- III. From any required accessible car parking space on the allotment

☐☐

✓

☐

✓

☐☐☐

✓

Reference: Figure 6, Figure 7, Figure 9, Figure 11, Figure 12, Figure 13, Figure 14

Notes: See Att. 01 – can be compliant at CC stage

(b) In a building required to be accessible,

- I. an accessway must be provided through the principal pedestrian entrance,
- II. through not less than 50% of all pedestrian entrances including the principal pedestrian entrance; and
- III. in a building with a total floor area more than 500 m², a pedestrian entrance which is not accessible must not be located more than 50 m from an accessible pedestrian entrance.

☐☐

✓

☐☐

✓

☐

✓

☐

Notes: See Att. 01 – can be compliant at CC stage

(c) Where a pedestrian entrance required to be accessible has multiple doorways—

- I. if the pedestrian entrance consists of not more than 3 doorways — not less than 1 of those doorways must be accessible;
- II. if a pedestrian entrance consists of more than 3 doorways — not less than 50% of those doorways must be accessible

☐☐

✓

☐☐

✓

Notes: See Att. 01 – can be compliant at CC stage

(d) Access way must have a clear opening of 850mm in accordance with 1428.1

☐☐

✓

Reference: Figure 23

Notes: See Att. 01 – can be compliant at CC stage

D3.3 Access To Buildings	ADR	N/A	C															
<p>(a) every ramp and stairway must comply with;</p> <p>I. For a ramp, clause 10 of AS 1428.1</p> <p>II. For a stairway, clause 11 of AS 1428.1</p> <p>III. For a fire isolated stair, clause 11.1(f) and (g) of AS 1428.1</p> <p>Reference: Figure 4, Figure 5, Figure 6, Figure 7, Figure 8, Figure 9, Figure 10, Figure 11, Figure 12, Figure 13, Figure 14, Figure 15</p> <p>Notes: See Att. 01 – can be compliant at CC stage</p>	<div><input type="checkbox"/></div> <div><input type="checkbox"/></div> <div><input type="checkbox"/></div>	<div><input type="checkbox"/></div> <div><input type="checkbox"/></div> <div><input type="checkbox"/></div>	<div>✓</div> <div>✓</div> <div>✓</div>															
<p>(b) every passenger lift must comply with E3.6</p> <p>Notes: Can be complaint at CC stage – This has been assessed in further detail in Part E3 further in this report</p>	<div><input type="checkbox"/></div>	<div><input type="checkbox"/></div>	<div>✓</div>															
<p>(c) access ways must have;</p> <p>I. Passing spaces complying with AS 1428.1</p> <p>II. Turning spaces complying with AS 1428.1</p> <p>i. Within 2m of the end of access ways where it is not possible to continue.</p> <p>ii. at maximum 20m intervals along the access way</p> <p>Reference: Figure 1, Figure 2, Figure 3</p> <p>Notes: See Att. 01 – can be compliant at CC stage</p>	<div><input type="checkbox"/></div> <div><input type="checkbox"/></div> <div><input type="checkbox"/></div>	<div><input type="checkbox"/></div> <div><input type="checkbox"/></div> <div><input type="checkbox"/></div>	<div>✓</div> <div>✓</div> <div>✓</div>															
<p>(d) an intersection of access way satisfies the spatial requirements for a passing and turning space</p> <p>Reference: Figure 1</p> <p>Notes: See Att. 01 – can be compliant at CC stage</p>	<div><input type="checkbox"/></div>	<div><input type="checkbox"/></div>	<div>✓</div>															
<p>(e) a passing space may serve as a turning space</p> <p>Reference: Figure 1</p> <p>Notes: See Att. 01 – can be compliant at CC stage</p>	<div><input type="checkbox"/></div>	<div><input type="checkbox"/></div>	<div>✓</div>															
<p>(f) a ramp complying with AS 1428.1 or a passenger lift need not be provided to serve a storey or level other than the entrance storey in class 5, 6, 7b or 8</p> <p>I. Containing not more than 3 storeys and</p> <p>II. With a floor area for each storey, excluding the entrance storey, of not more than 200m²</p>	<div><input type="checkbox"/></div>	<div>✓</div>	<div><input type="checkbox"/></div>															
<p>(g) Clause 7.4.1(a) of AS 1428.1 does not apply. Replaces with pile thickness not exceeding 11mm and carpet backing thickness not exceeding 4mm</p> <p>Notes: See Att. 01 – can be compliant at CC stage</p>	<div><input type="checkbox"/></div>	<div><input type="checkbox"/></div>	<div>✓</div>															
<p>Slip Resistance Requirements as per the BCA</p> <p>BCA table D2.14 has the following slip resistance requirements/classification when tested in accordance with AS4586</p> <p>Table D2.14 Slip-resistance classification</p> <table><tr><th>Application</th><th>Dry surface conditions</th><th>Wet surface conditions</th></tr><tr><td>Ramp steeper than 1:14</td><td>P4 or R11</td><td>P5 or R12</td></tr><tr><td>Ramp steeper than 1:20 but not steeper than 1:14</td><td>P3 or R10</td><td>P4 or R11</td></tr><tr><td>Tread or landing surface</td><td>P3 or R10</td><td>P4 or R11</td></tr><tr><td>Nosing or landing edge strip</td><td>P3</td><td>P4</td></tr></table> <p>Notes: Can be complaint at CC stage – the builder must provide a certificate stating that the slip resistance of all surfaces complies with the above table D2.14 when tested in accordance with AS4586</p>	Application	Dry surface conditions	Wet surface conditions	Ramp steeper than 1:14	P4 or R11	P5 or R12	Ramp steeper than 1:20 but not steeper than 1:14	P3 or R10	P4 or R11	Tread or landing surface	P3 or R10	P4 or R11	Nosing or landing edge strip	P3	P4	<div><input type="checkbox"/></div>	<div><input type="checkbox"/></div>	<div>✓</div>
Application	Dry surface conditions	Wet surface conditions																
Ramp steeper than 1:14	P4 or R11	P5 or R12																
Ramp steeper than 1:20 but not steeper than 1:14	P3 or R10	P4 or R11																
Tread or landing surface	P3 or R10	P4 or R11																
Nosing or landing edge strip	P3	P4																

(b) signage including the international symbol for deafness in accordance with AS 1428.1 must be provided within a room containing a hearing augmentation system identifying— I. The type of hearing augmentation. II. The area covered within the room. If receivers are being used and where the receivers can be obtained.	<input type="checkbox"/>	<input checked="" type="checkbox"/>	<input type="checkbox"/>
(c) Signage in accordance with AS 1428.1 must be provided for accessible unisex sanitary facilities to identify if the facility is suitable for left (LH) or right (RH) handed use. Reference: Figure 17 Notes: See Att. 01 – can be compliant at CC stage	<input type="checkbox"/>	<input type="checkbox"/>	<input checked="" type="checkbox"/>
(d) Signage to identify an ambulant accessible sanitary facility in accordance with AS 1428.1 must be located on the door of the facility. Reference: Figure 17 Notes: See Att. 01 – can be compliant at CC stage	<input type="checkbox"/>	<input type="checkbox"/>	<input checked="" type="checkbox"/>
(e) where a pedestrian entrance is not accessible, directional signage in accordance with AS 1428.1 must be provided to direct a person to the location of the nearest accessible pedestrian entrance. Notes: Main pedestrian entrance is accessible	<input type="checkbox"/>	<input checked="" type="checkbox"/>	<input type="checkbox"/>
(f) where a bank of sanitary facilities is not provided with an accessible unisex sanitary facility, directional signage in accordance with AS 1428.1 must be placed at the location of the sanitary facilities that are not accessible, to direct a person to the location of the nearest accessible unisex sanitary facility.	<input type="checkbox"/>	<input checked="" type="checkbox"/>	<input type="checkbox"/>
g) in a building subject to F2.9, directional signage complying with Specification D3.6 must be provided at the location of each— i. bank of sanitary facilities; and ii. accessible unisex sanitary facility, other than one that incorporates an accessible adult change facility, to direct a person to the location of the nearest accessible adult change facility within that building.	<input type="checkbox"/> <input type="checkbox"/>	<input checked="" type="checkbox"/> <input checked="" type="checkbox"/>	<input type="checkbox"/> <input type="checkbox"/>
All braille and tactile signage must comply with Specification D3.6 braille and tactile signs Reference: Figure 19 Notes: See Att. 01 – can be compliant at CC stage	<input type="checkbox"/>	<input type="checkbox"/>	<input checked="" type="checkbox"/>
D3.7 Hearing augmentation	ADR	N/A	C
(a) a hearing augmentation system must be provided where an inbuilt amplification system other than the one used only for emergency warning, is installed; I. In a room in a Class 9b building II. In an auditorium, conference room, meeting room or room for judicatory purposes III. At any ticket office, teller's booth, reception area or the like, where the public is screened from the service provider	<input type="checkbox"/> <input type="checkbox"/> <input type="checkbox"/>	<input checked="" type="checkbox"/> <input checked="" type="checkbox"/> <input checked="" type="checkbox"/>	<input type="checkbox"/> <input type="checkbox"/> <input type="checkbox"/>
D3.8 Tactile indicators	ADR	N/A	C
(a) For a building required to be accessible, tactile ground surface indicators must be provided to warn people who are blind or have a vision impairment that they are approaching— I. A stairway, other than a fire-isolated stairway. II. An escalator. III. A passenger conveyor or moving walk. IV. A ramp other than a fire-isolated ramp, step ramp, kerb ramp or swimming pool ramp. V. Under an overhead obstruction less than 2 m above floor level, other than a doorway if no barrier is present. VI. Or when an access way meets a vehicular way adjacent to any pedestrian entrance to a building, if there is no kerb or kerb ramp present. Reference: Figure 04, Figure 12, Figure 15 Notes: See Att. 01 – can be compliant at CC stage	<input type="checkbox"/> <input type="checkbox"/> <input type="checkbox"/> <input type="checkbox"/> <input type="checkbox"/> <input type="checkbox"/>	<input type="checkbox"/> <input checked="" type="checkbox"/> <input checked="" type="checkbox"/> <input type="checkbox"/> <input checked="" type="checkbox"/> <input checked="" type="checkbox"/>	<input checked="" type="checkbox"/> <input type="checkbox"/> <input type="checkbox"/> <input checked="" type="checkbox"/> <input type="checkbox"/> <input type="checkbox"/>

(b) Tactile ground surface indicators must comply with sections 1 and 2 of AS/NZS 1428.4.1. Reference: Figure 15 Notes: See Att. 01 – can be compliant at CC stage	<input type="checkbox"/>	<input type="checkbox"/>	✓
(c) A hostel for the aged, nursing home for the aged, a residential aged care building Class 3 accommodation for the aged, Class 9a health-care building or a Class 9c building need not comply with (a)(i) and (iv) if handrails incorporating a raised dome button in accordance with the requirements for stairway handrails in AS 1428.1 are provided to warn people who are blind or have a vision impairment that they are approaching a stairway or ramp.	<input type="checkbox"/>	✓	<input type="checkbox"/>
D3.9 Wheelchair seating spaces in Class 9b assembly buildings	ADR	N/A	C
Only applicable for class 9b building	<input type="checkbox"/>	✓	<input type="checkbox"/>
D3.10 Swimming pools	ADR	N/A	C
Only applicable where swimming pool is provided	<input type="checkbox"/>	✓	<input type="checkbox"/>
D3.11 Ramps	ADR	N/A	C
(a) a series of connected ramps must not have a combined vertical rise of more than 3.6m	<input type="checkbox"/>	✓	<input type="checkbox"/>
(b) a landing for a step ramp must not overlap a landing for another step ramp or ramp	<input type="checkbox"/>	✓	<input type="checkbox"/>
D3.12 Glazing on an access way	ADR	N/A	C
On an access way where there is no chair rail, handrail or transom, all frameless or fully glazed doors, sidelights and any glazing capable of being mistaken for a doorway or opening, must be clearly marked in accordance with AS 1428.1 Reference: Figure 16 Notes: Can be complaint at CC stage – selection of glazing strips as specified in this section will lead to compliance at construction stage. This to be confirmed at CC stage.	<input type="checkbox"/>	<input type="checkbox"/>	✓

The references below to be read as set and referenced in each section of part D3

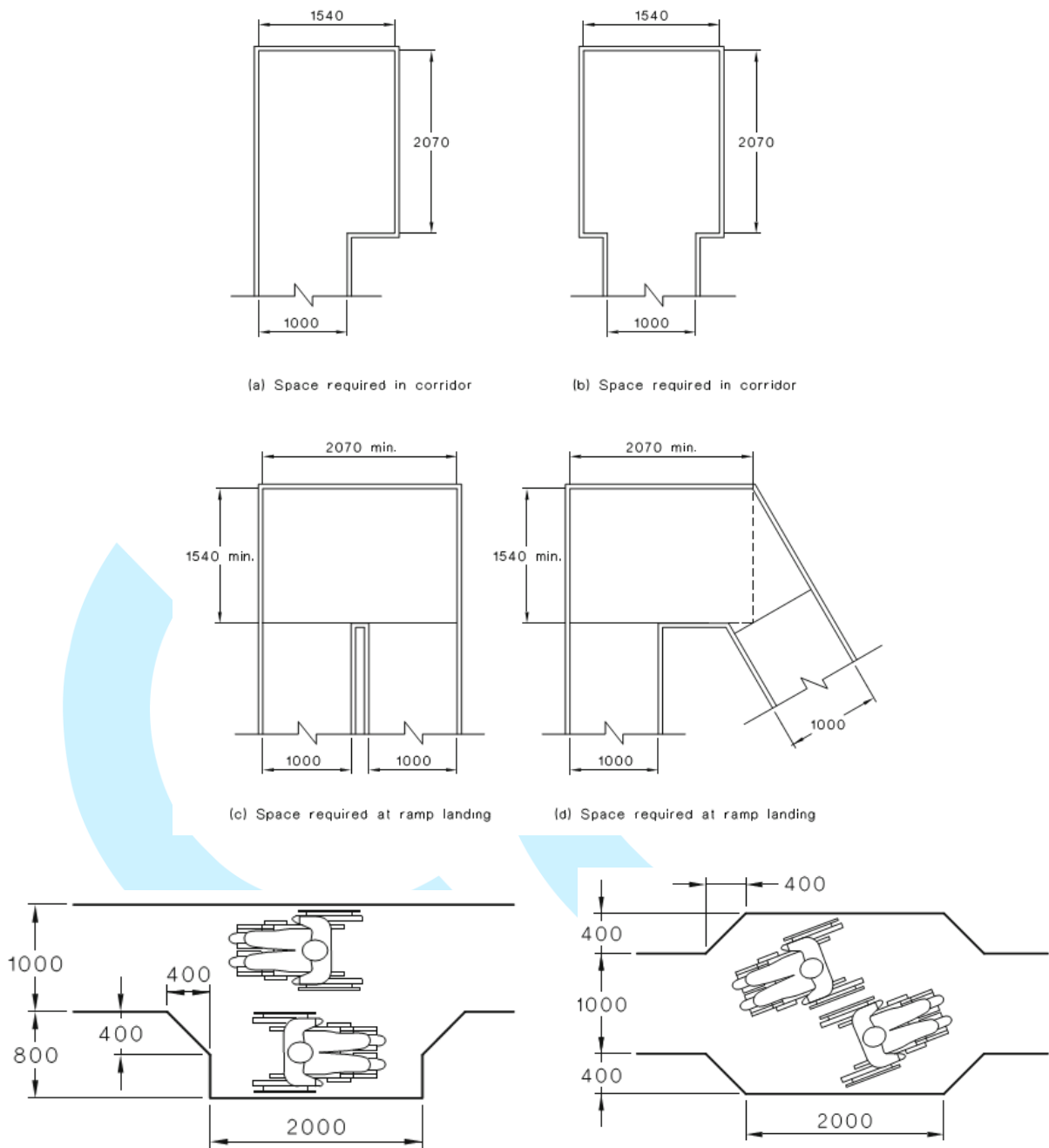

SAI Global Ltd License 1704-c045-2

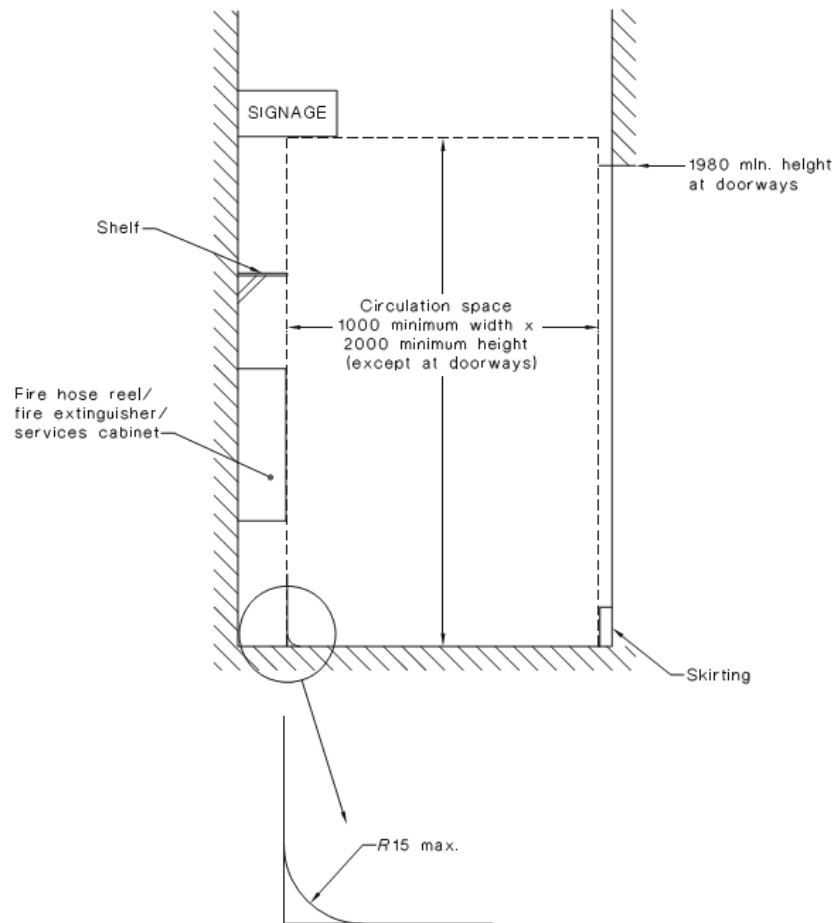

Figure 2

SAI Global Ltd License 1704-c045-2

Unless otherwise specified (such as at doors, curved ramps and similar), the minimum unobstructed width (see Figure 2) of a continuous accessible path of travel shall be 1000 mm and the following shall not intrude into the minimum unobstructed width of a continuous accessible path of travel:

- (a) Fixtures and fittings such as lights, awnings, windows that, when open, intrude into the circulation space, telephones, skirtings and similar objects.
- (b) Essential fixtures and fittings such as fire hose reels, fire extinguishers and switchboards.
- (c) Door handles less than 900 mm above the finished floor level.

Figure 3

SAI Global Ltd License 1704-c045-2

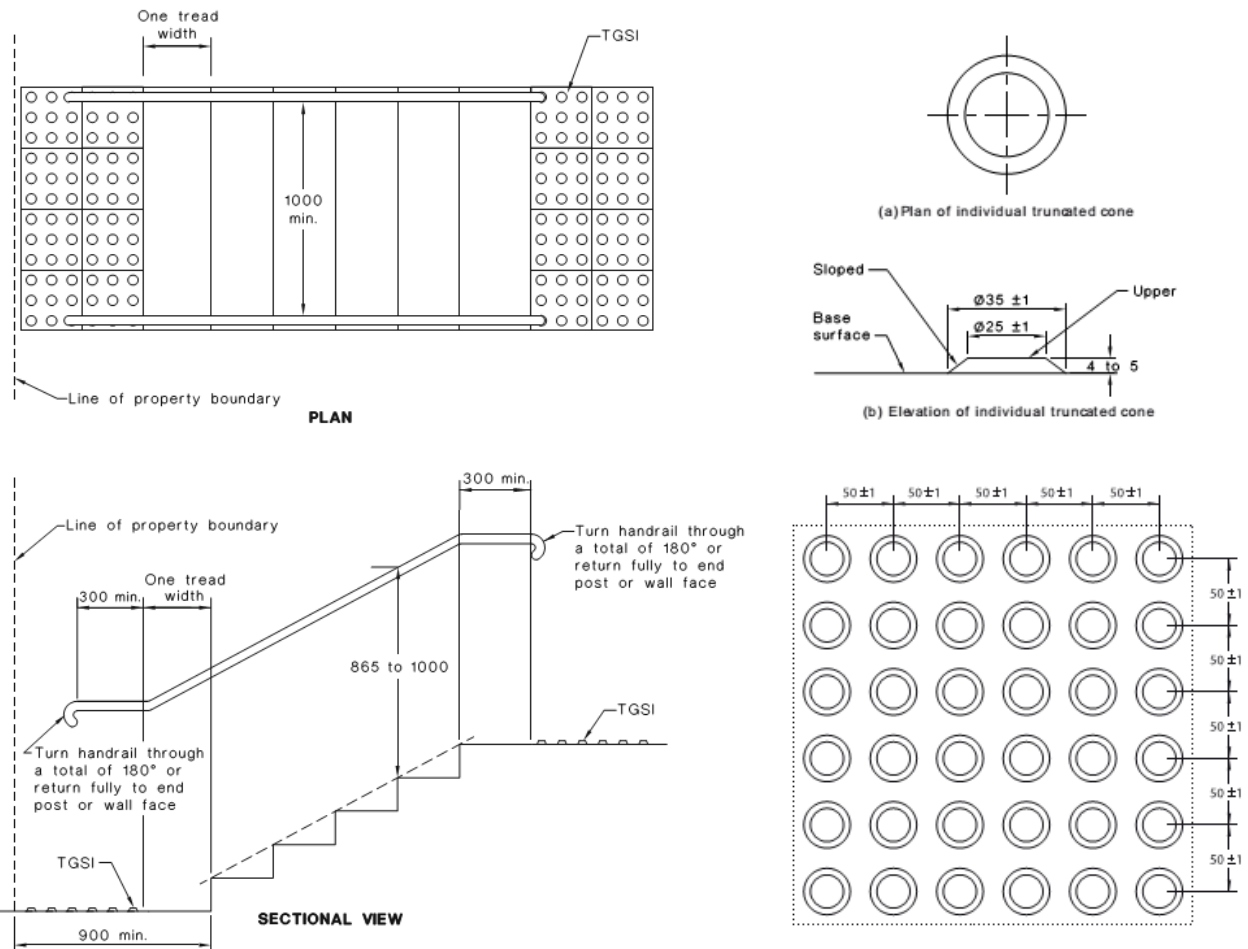
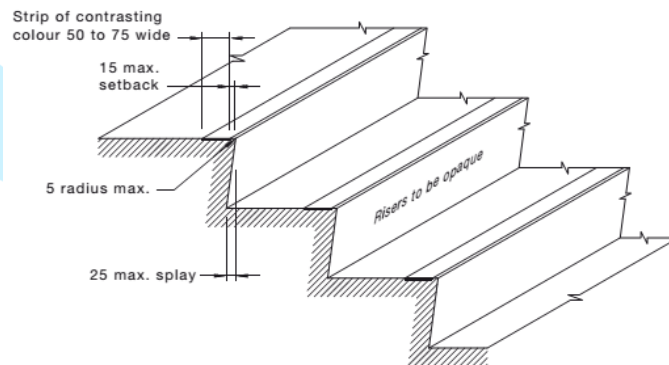

Figure 4

SAI Global Ltd License 1704-c045-2



NOTE: A chamfered nosing 5 × 5 mm may be used.

DIMENSIONS IN MILLIMETRES

FIGURE 27(A) A TYPICAL STAIR NOSING PROFILE WITH NOSING STRIP

Figure 5

SAI Global Ltd License 1704-c045-2

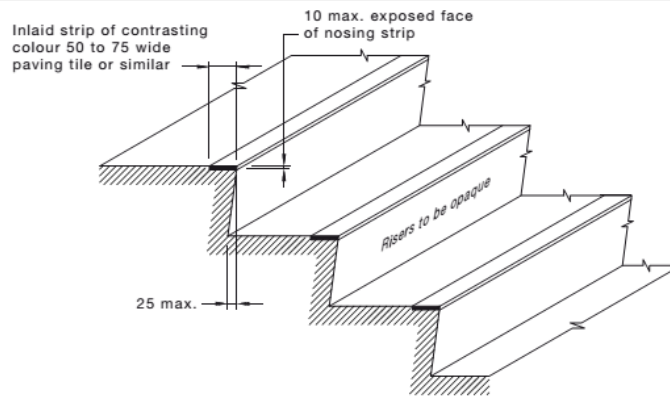

DIMENSIONS IN MILLIMETRES

FIGURE 27(B) A TYPICAL STAIR NOSING PROFILE WITH EXPOSED NOSING STRIP

Figure 6 SAI Global Ltd License 1704-c045-2

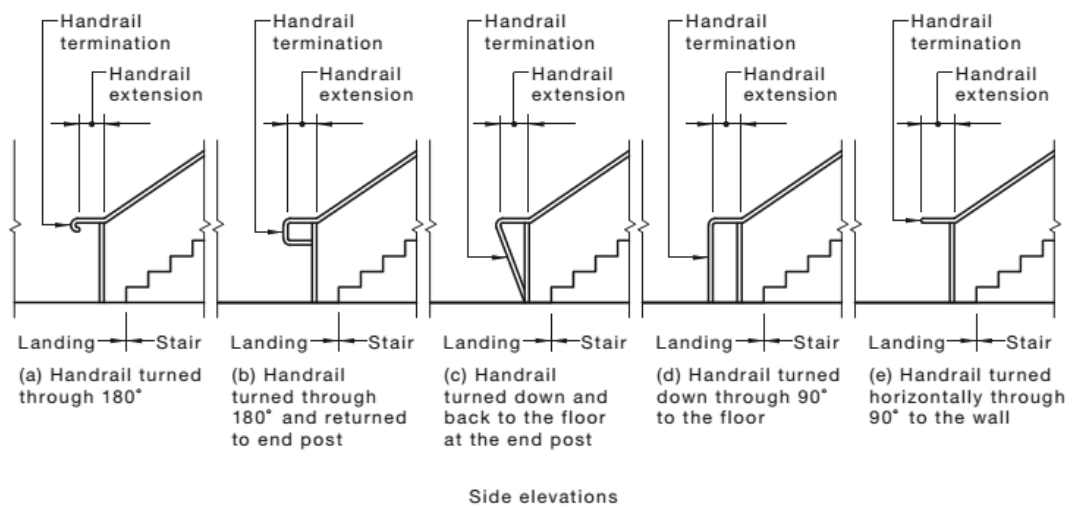

Side elevations

FIGURE 26(C) STAIR HANDRAILS—HANDRAIL TERMINATIONS

Figure 7

SAI Global Ltd License 1704-c045-2

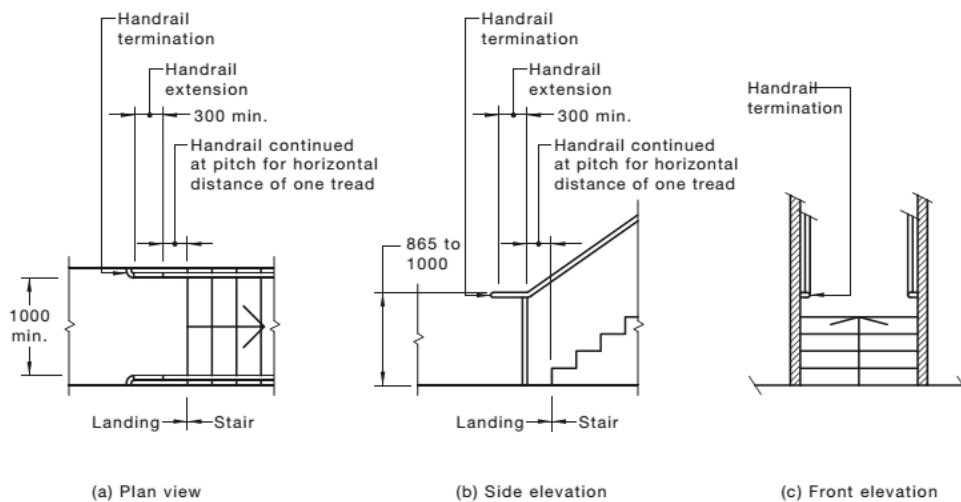

DIMENSIONS IN MILLIMETRES

FIGURE 26(D) DETAIL FOR HANDRAILS TERMINATED BY TURNING HORIZONTALLY THROUGH 90° TO THE WALL

Figure 8

SAI Global Ltd License 1704-c045-2

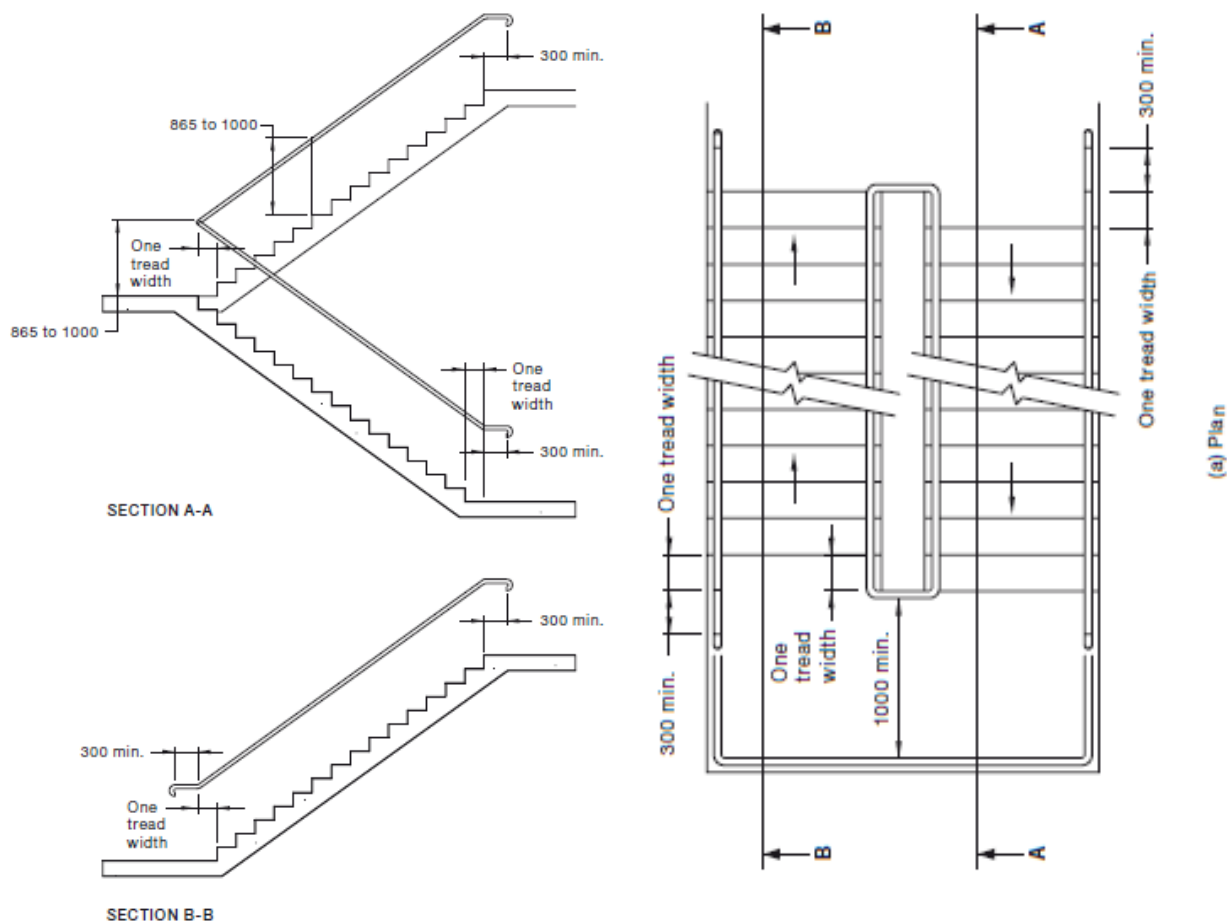

Figure 9

SAI Global Ltd License 1704-c045-2

- Handrails and balustrades shall not encroach into required circulation spaces.
- The cross-section of handrails shall be circular or elliptical, not less than 30 mm or greater than 50 mm in height or width for not less than 270° around the uppermost surface as shown in Figures 29(a) and 29(b). Elliptical handrails shall have the greater dimension in the horizontal axis as shown in Figure 29(b).
- Exposed edges at ends and corners of handrails shall have a radius of not less than 5 mm.
- The top of handrails shall be not less than 865 mm nor more than 1000 mm above the nosing of stairway tread or the plane of the finished floor of the walkway, ramp or landing.
- The height of the top of the handrail, measured in accordance with Item (d), shall be consistent through the ramp (or stairs) and any landings.
- If a balustrade is required at a height greater than the handrail, both shall be provided.
- Handrails shall be securely fixed and rigid, and their ends shall be turned through a total of 180°, or to the ground, or returned fully to end post or wall face, as shown in Figures 26(C) and 26(D).
- The clearance between a handrail and an adjacent wall surface or other obstruction shall be not less than 50 mm. This clearance shall extend above the top of the handrail by not less than 600 mm.
- Handrails shall have no obstruction to the passage of a hand along the rail, as shown in Figures 29(a) and 29(b).
- The inside handrail at landings shall always be continuous, as shown in Figure 28(a).

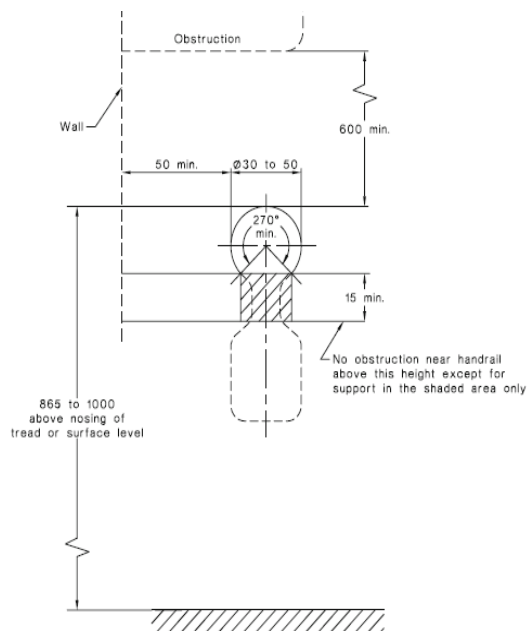

Figure 10

SAI Global Ltd License 1704-c045-2

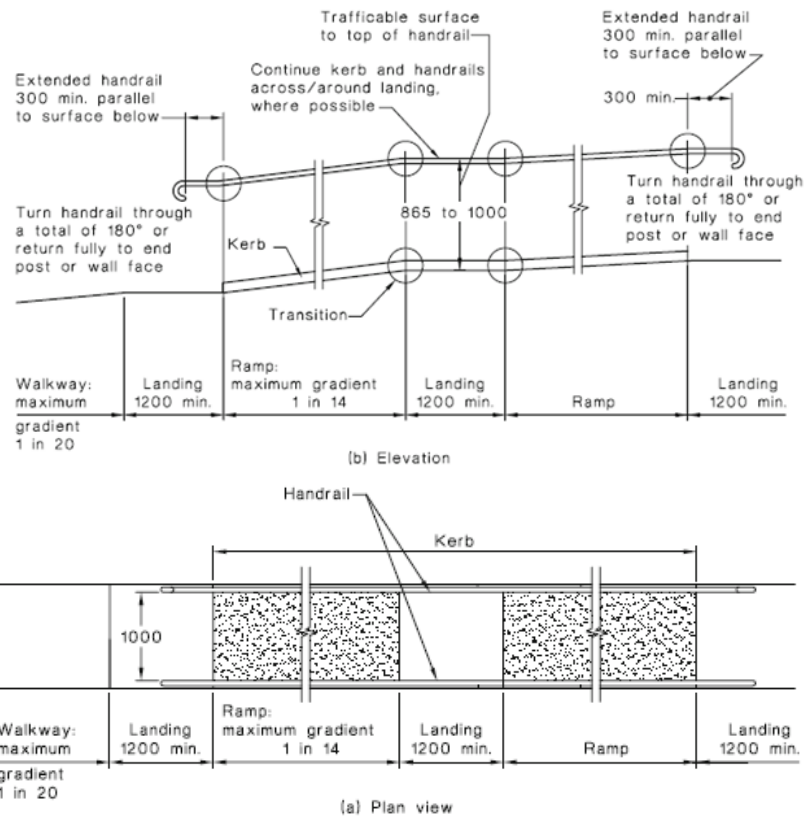
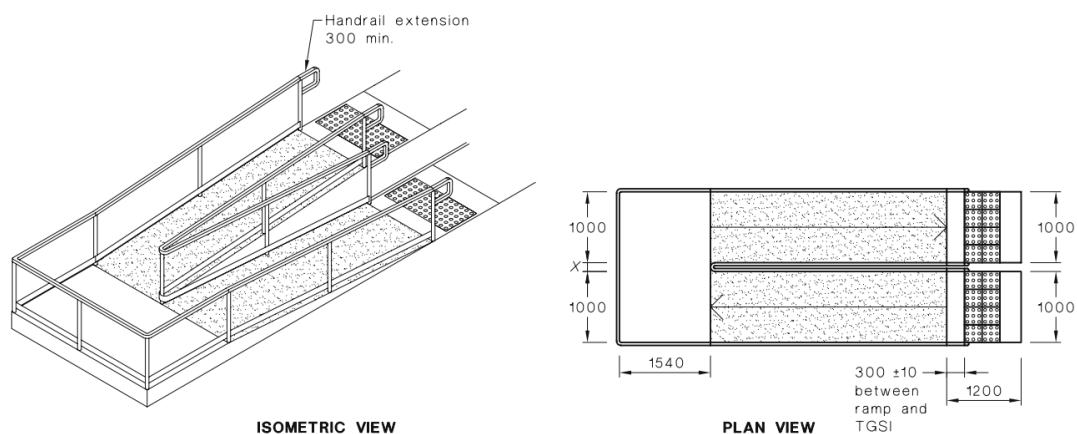
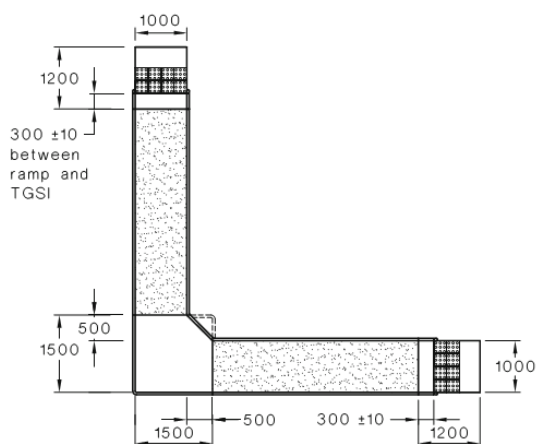

Figure 11

SAI Global Ltd License 1704-c045-2



DIMENSIONS IN MILLIMETRES



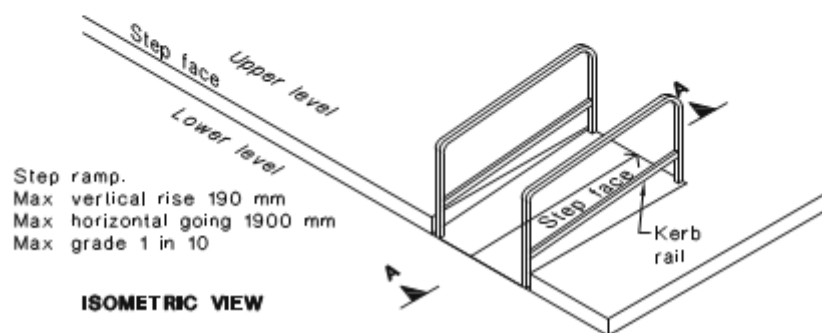
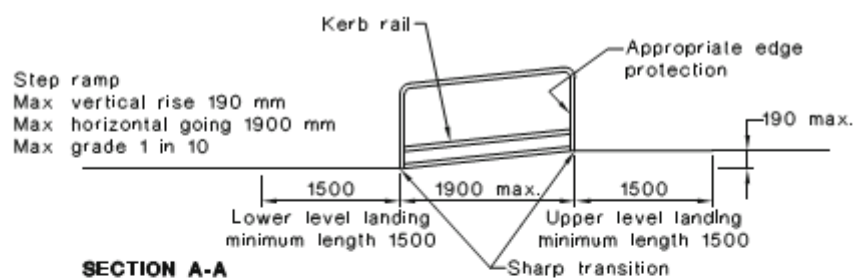
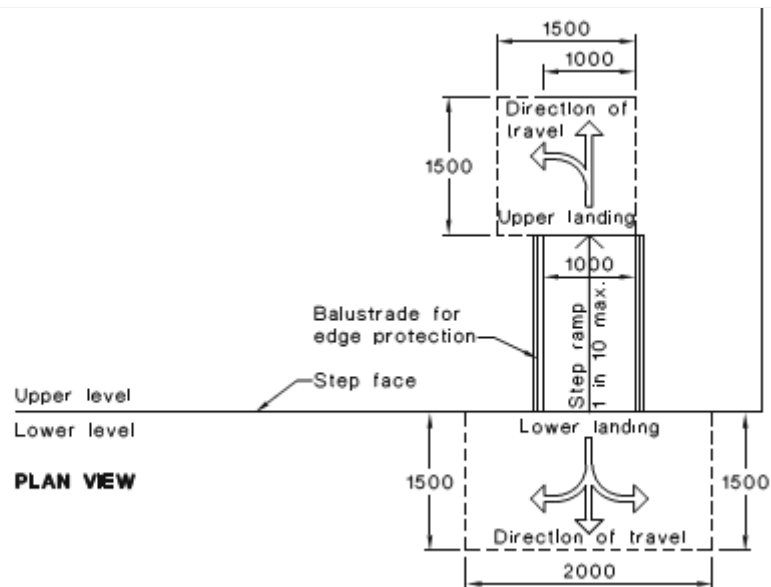

10.2 Walkways

Walkways shall comply with the following:

- (a) The floor or ground surface abutting the sides of the walkway shall provide a firm and level surface of a different material to that of the walkway at the same level of the walkway, follow the grade of the walkway and extend horizontally for a minimum of 600 mm unless one of the following is provided:
 - (i) Kerb in accordance with Figure 18.
 - (ii) Kerb rail and handrail in accordance with Figure 19.

- (iii) A wall not less than 450 mm in height.
- (b) Walkways shall be provided with landings, as specified in Clause 10.8, at intervals not exceeding the following:
 - (i) For walkway gradients of 1 in 33, at intervals no greater than 25 m.
 - (ii) For walkway gradients of 1 in 20, at intervals no greater than 15 m.
 - (iii) For walkway gradients between 1 in 20 to 1 in 33, at intervals that shall be obtained by linear interpolation.

For walkways shallower than 1 in 33, no landings are required.

The intervals specified above may be increased by 30% where at least one side of a walkway is bounded by—

- (A) a kerb or kerb rail as specified in Clause 10.3(j) and a handrail as specified in Clause 12; or
- (B) a wall and a handrail as specified in Clause 12.

Figure 12

SAI Global Ltd License 1704-c045-2

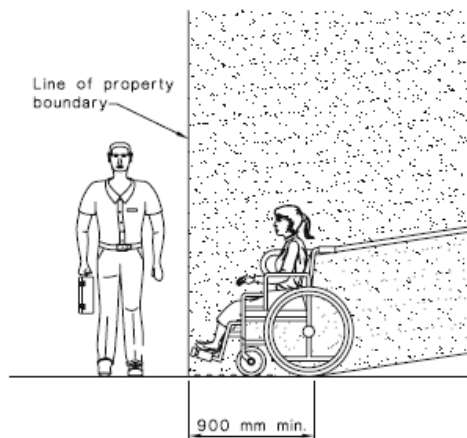

Figure 13 SAI Global Ltd License 1704-c045-2

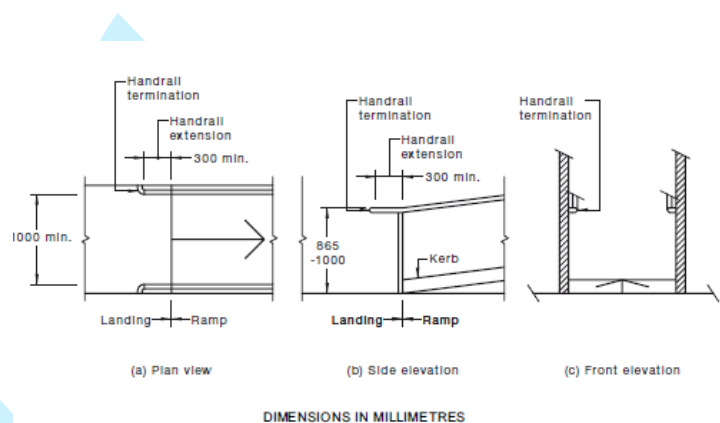

Figure 14

SAI Global Ltd License 1704-c045-2

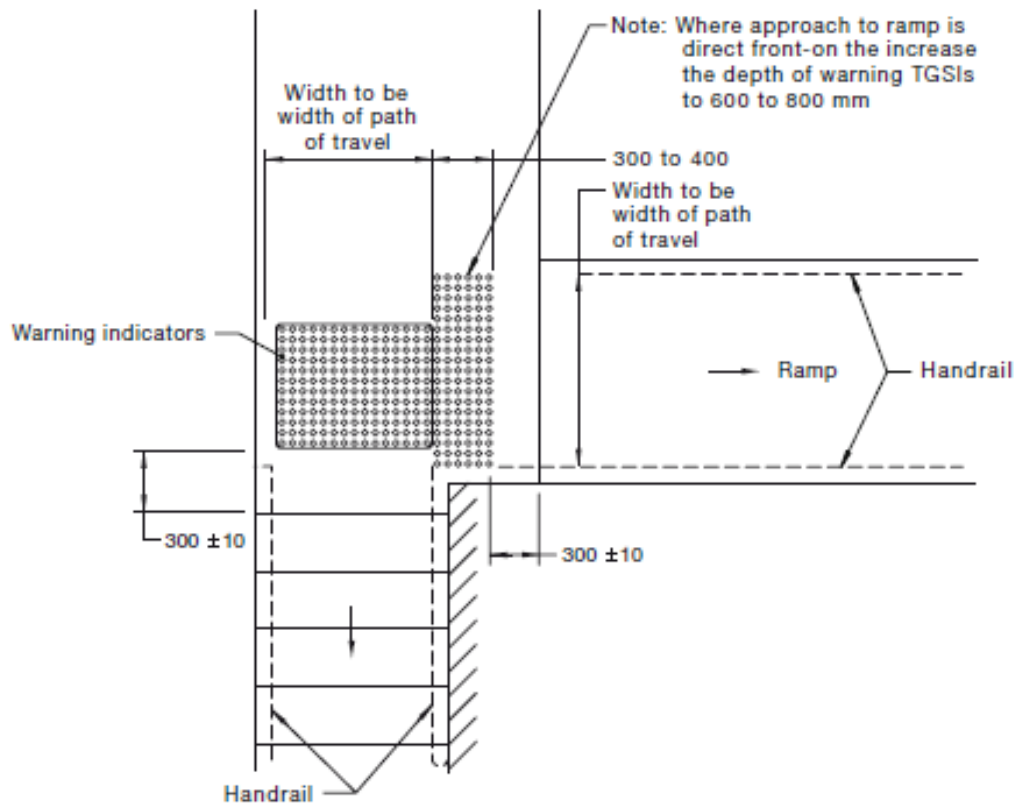

Figure 15

SAI Global Ltd License 1704-c045-2

Where there is no chair rail, handrail or transom, all frameless or fully glazed doors, sidelights, including any glazing capable of being mistaken for a doorway or opening, shall be clearly marked for their full width with a solid contrasting line. The contrasting line shall be not less than 75 mm wide and shall extend across the full width of the glazing panel. The lower edge of the contrasting line shall be located between 900 mm and 1000 mm above the plane of the finished floor level.

Any contrasting line on the glazing shall provide a minimum of 30% luminance contrast when viewed against the floor surface or surfaces within 2 m of the glazing on the opposite side.

Figure 16

SAI Global Ltd License 1704-c045-2



Figure 17

SAI Global Ltd License 1704-c045-2



SAI Global Ltd License 1704-c045-2

- (a) Tactile characters must be raised or embossed to a height of not less than 1 mm and not more than 1.5 mm.
- (b) Sentence case (upper case for the first letter of each main word and lower case for all other letters) must be used for all tactile characters, and—
 - (i) upper case tactile characters must have a height of not less than 15 mm and not more than 55 mm, except that the upper case tactile characters on a sign identifying a door *required* by E4.5 to be provided with an *exit* sign must have a height of not less than 20 mm and not more than 55 mm; and
 - (ii) lower case tactile characters must have a height of 50% of the related upper case characters.
- (c) Tactile characters, symbols, and the like, must have rounded edges.
- (d) The entire sign, including any frame, must have all edges rounded.
- (e) The background, negative space or fill of signs must be of matt or low sheen finish.
- (f) The characters, symbols, logos and other features on signs must be matt or low sheen finish.
- (g) The minimum letter spacing of tactile characters on signs must be 2 mm.
- (h) The minimum word spacing of tactile characters on signs must be 10 mm.
- (i) The thickness of letter strokes must be not less than 2 mm and not more than 7 mm.
- (j) Tactile text must be left justified, except that single words may be centre justified.
- (k) Tactile text must be Arial typeface.

SAI Global Ltd License 1704-c045-2

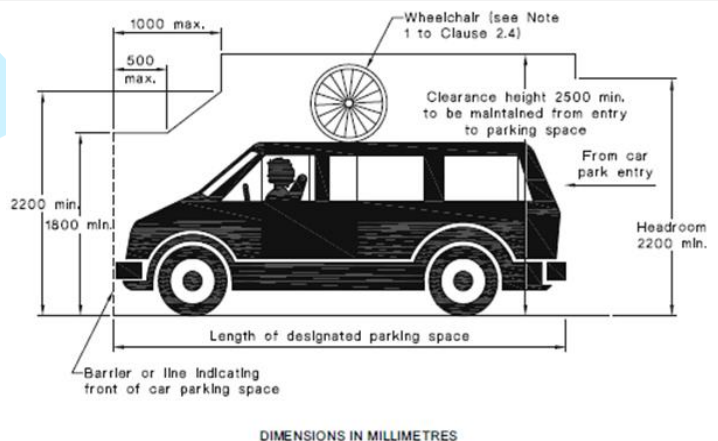

SAI Global Ltd License 1704-c045-2

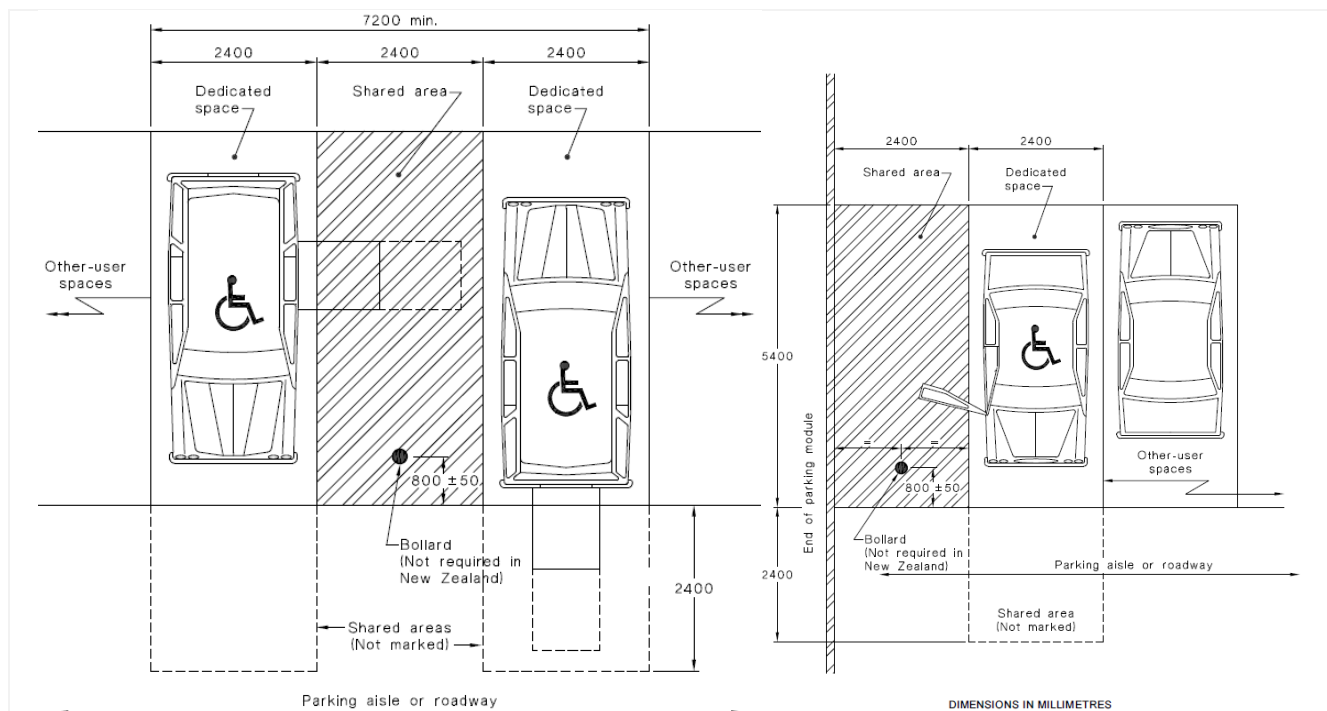
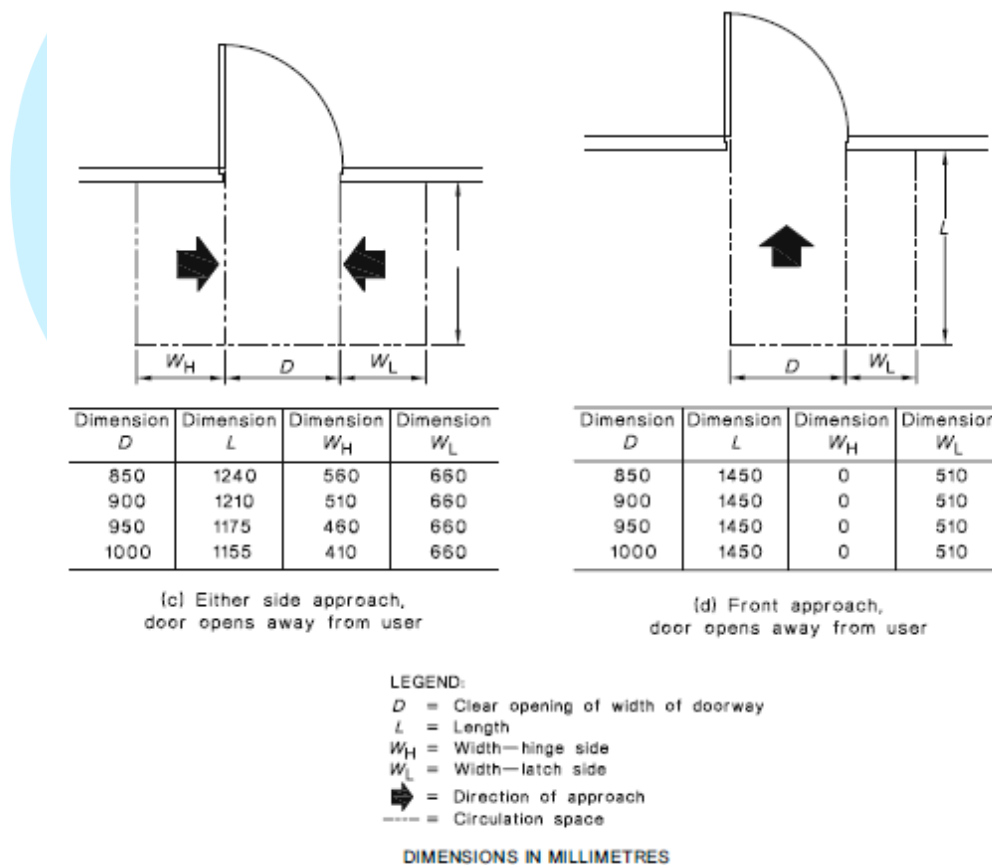
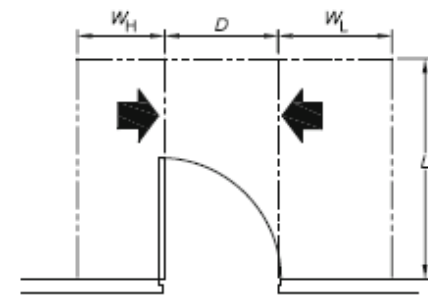

Figure 22

SAI Global Ltd License 1704-c045-2





Dimension D	Dimension L	Dimension W_H	Dimension W_L
850	1670	660	900
900	1670	610	900
950	1670	560	900
1000	1670	510	900

(g) Either side approach,
door opens towards user

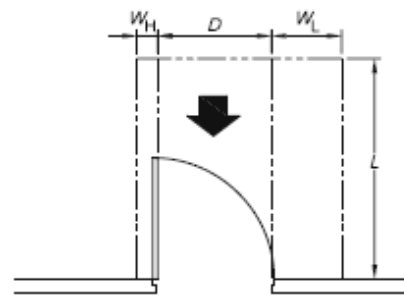

Dimension D	Dimension L	Dimension W_H	Dimension W_L
850	1450	110	530
900	1450	110	530
950	1450	110	530
1000	1450	110	530

(h) Front approach,
door opens towards user

LEGEND:

D = Clear opening of width of doorway

L = Length

W_H = Width—hinge side

W_L = Width—latch side

→ = Direction of approach

--- = Circulation space

DIMENSIONS IN MILLIMETRES

Figure 23

SAI Global Ltd License 1704-c045-2

The attachments below are extracted from the Architectural Plans provided and are to be read as set and referenced in each section of part D3





Ground Floor



Ground Mezzanine

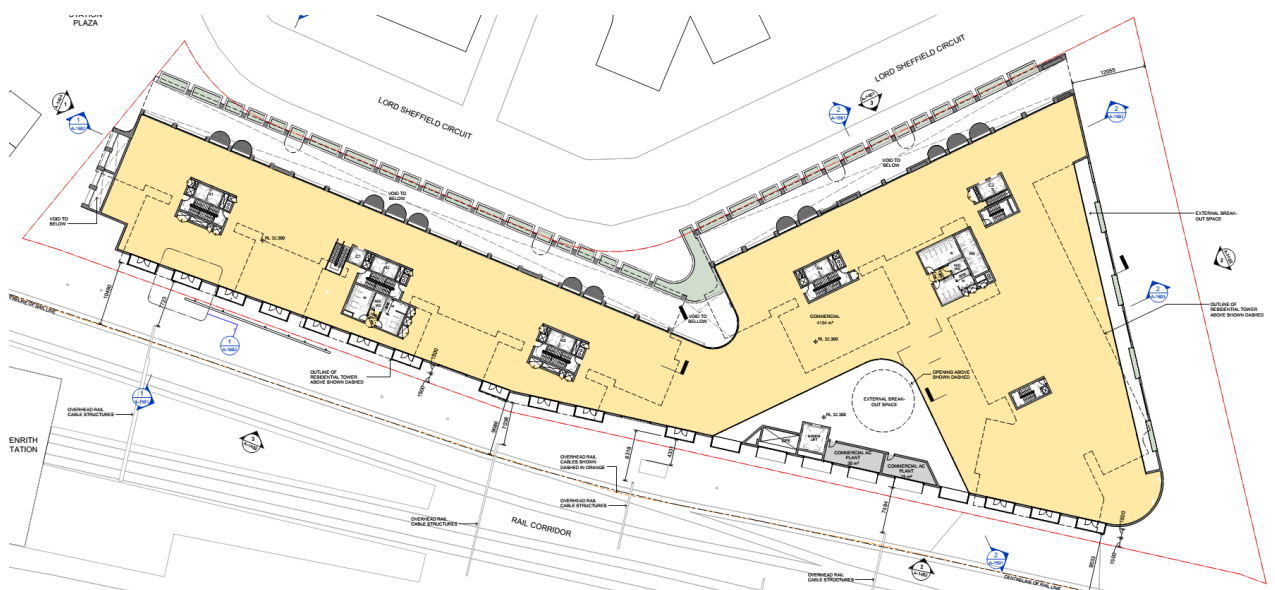

Level 01



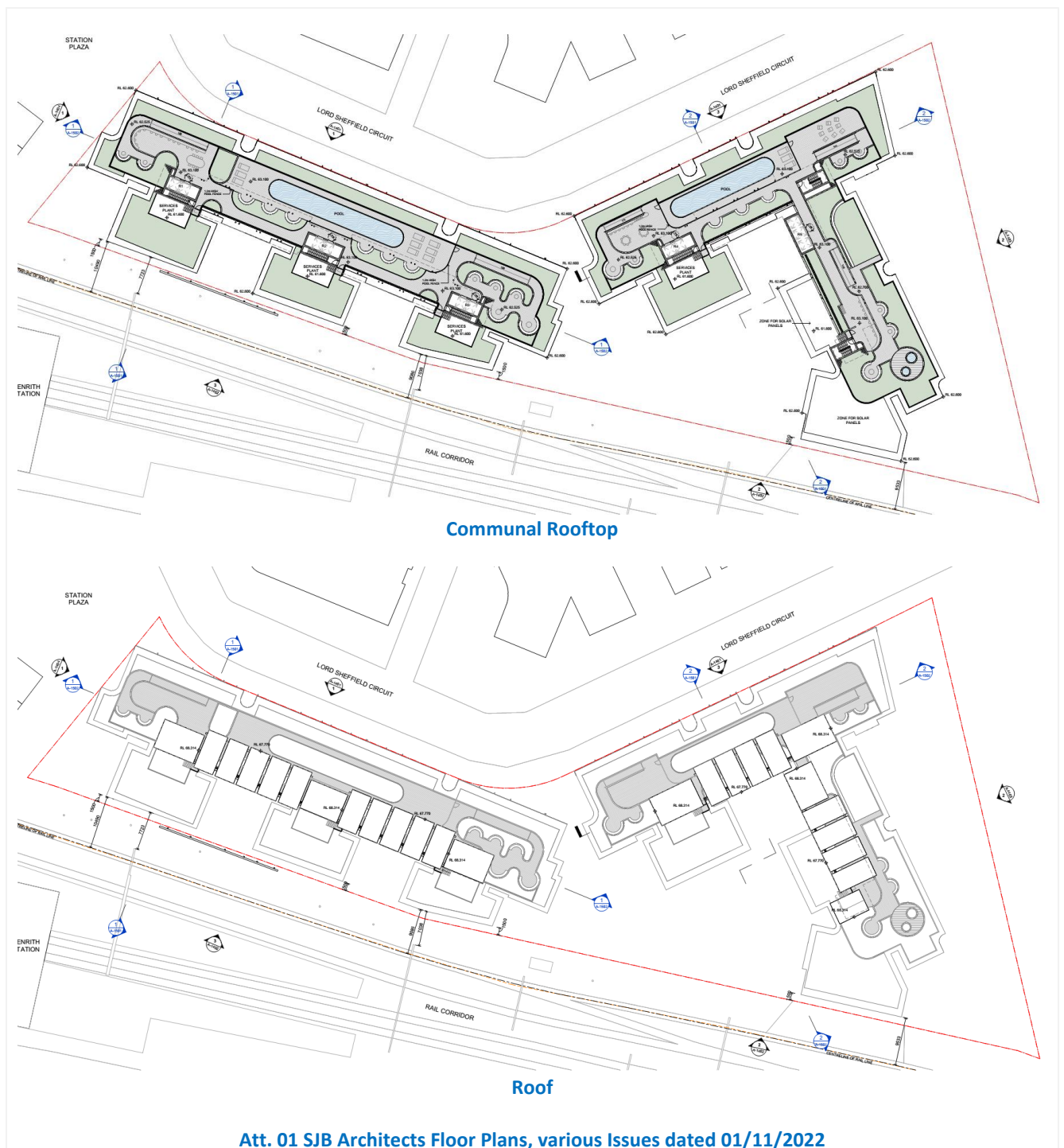

AS 1428.1 – Additional Requirements

The additional requirements set below to be read in full	ADR	N/A	C
<p>1. Access ways:</p> <ul style="list-style-type: none"> All access ways must have a minimum width of 1m clear and a vertical clearance of at least 2m. <p>Reference: Figure 24, Figure 25 Notes: See Att.01 – capable of compliance at CC stage</p>	<input type="checkbox"/>	<input type="checkbox"/>	✓
<p>2. Doorway general requirements:</p> <ul style="list-style-type: none"> All doorways are to be in accordance with AS1428.1. Door thresholds are to be level or they can incorporate a threshold ramp as per AS1428.1 Distance between successive doorways in airlocks to be 1450mm which is measured when the door is in an open position in case of swinging doors <p>Reference: Figure 23, Figure 27, Figure 28 Notes: See Att.01 – capable of compliance at CC stage</p>	<input type="checkbox"/> <input type="checkbox"/> <input type="checkbox"/>	<input type="checkbox"/> <input type="checkbox"/> <input type="checkbox"/>	✓ ✓ ✓
<p>3. Door hardware:</p> <ul style="list-style-type: none"> Door hardware including door handles, door closers, snibs (in accessible toilets) are required to be as per the requirements in AS1428.1 <p>Reference: Figure 29 Notes: See Att.01 – capable of compliance at CC stage</p>	<input type="checkbox"/>	<input type="checkbox"/>	✓
<p>4. Luminance contrast requirements:</p> <ul style="list-style-type: none"> All doorways are to have a minimum luminance contrast of 30% and the minimum width of 50mm provided as per AS1428.1 <p>Reference: Figure 30 Notes: See Att.01 – capable of compliance at CC stage</p>	<input type="checkbox"/>	<input type="checkbox"/>	✓
<p>5. Floor Surfaces:</p> <ul style="list-style-type: none"> Use slip resistant surfaces. The texture of the surface shall be traversable by people who use a wheelchair and those with an ambulant or sensory disability. Abutment of surfaces shall have a smooth transition. Construction specifications to be as per AS1428.1. Any grates along the path must be as per AS1428.1 <p>Reference: Figure 31 Notes: See Att.01 – capable of compliance at CC stage</p>	<input type="checkbox"/>	<input type="checkbox"/>	✓
<p>6. Switches and Outlets:</p> <ul style="list-style-type: none"> All switches and controls on an accessible path of travel, other than general purpose outlets, shall be located not less than 900 mm nor more than 1100 mm above the plane of the finished floor and not less than 500 mm from internal corners. GPOs to be located between 600-1100mm above FFL and minimum of 500mm from any internal corners. Rocker action / toggle switches to be provided in with a minimum size of 30mmx30mm Push pad switches if used to have a minimum dimension of 25mm diameter All switches in accessible sole occupancy units or sanitary facilities are to be located as per AS1428.1 <p>Reference: Figure 32 Notes: See Att.01 – capable of compliance at CC stage</p>	<input type="checkbox"/>	<input type="checkbox"/>	✓

Additional Requirements – References

The references below to be read as set and referenced in each section of Additional Requirements

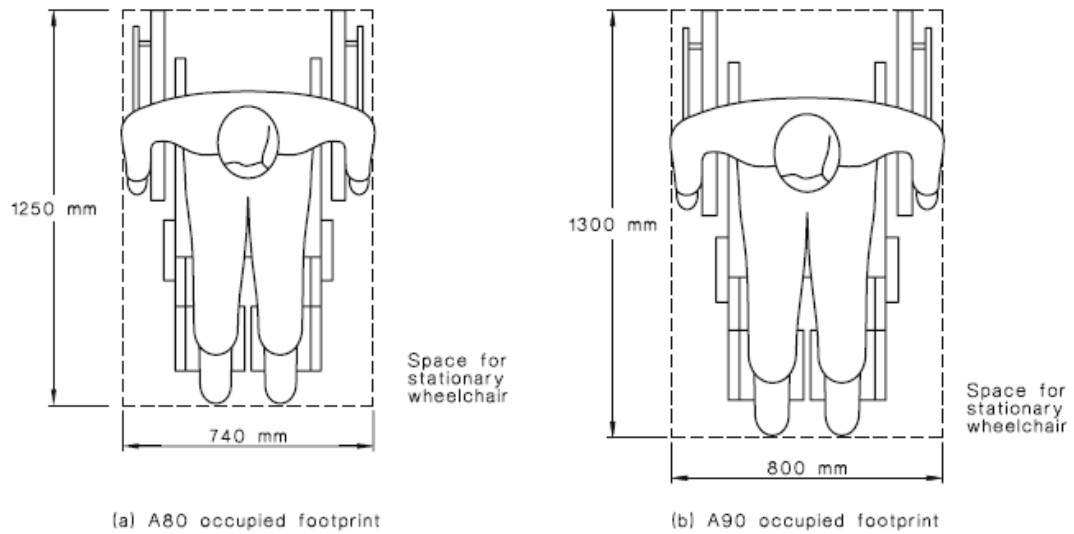

Figure 24

SAI Global Ltd License 1704-c045-2

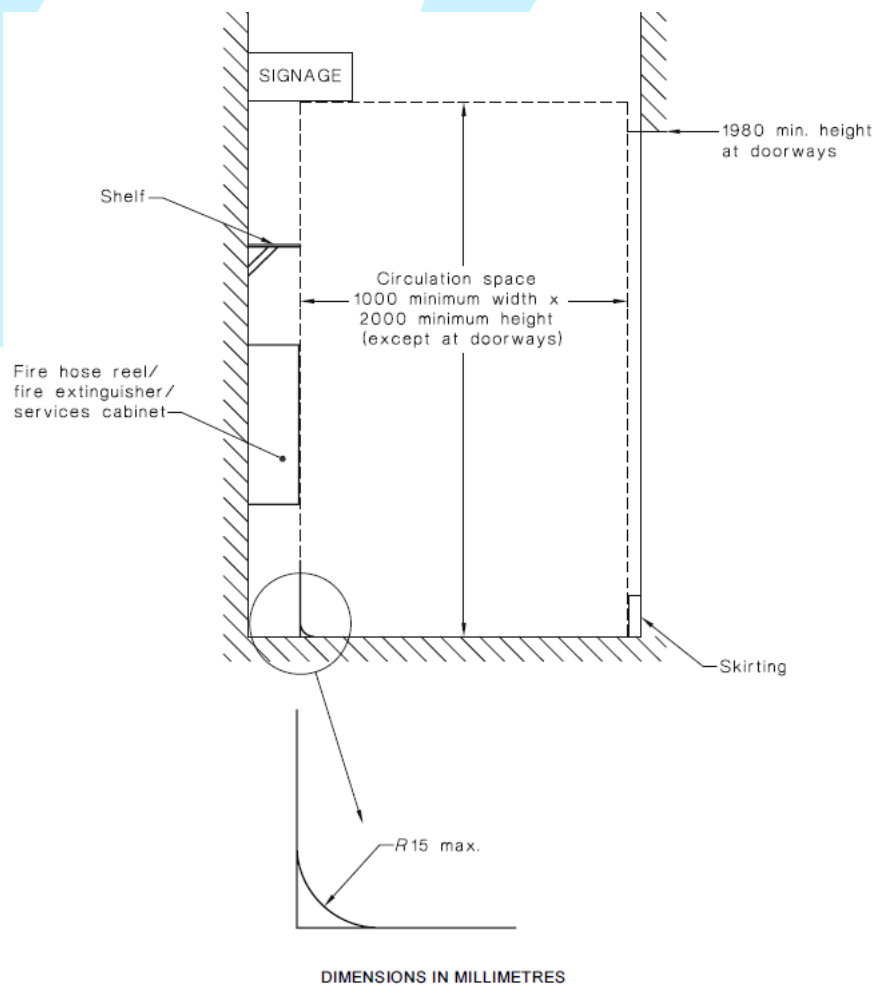
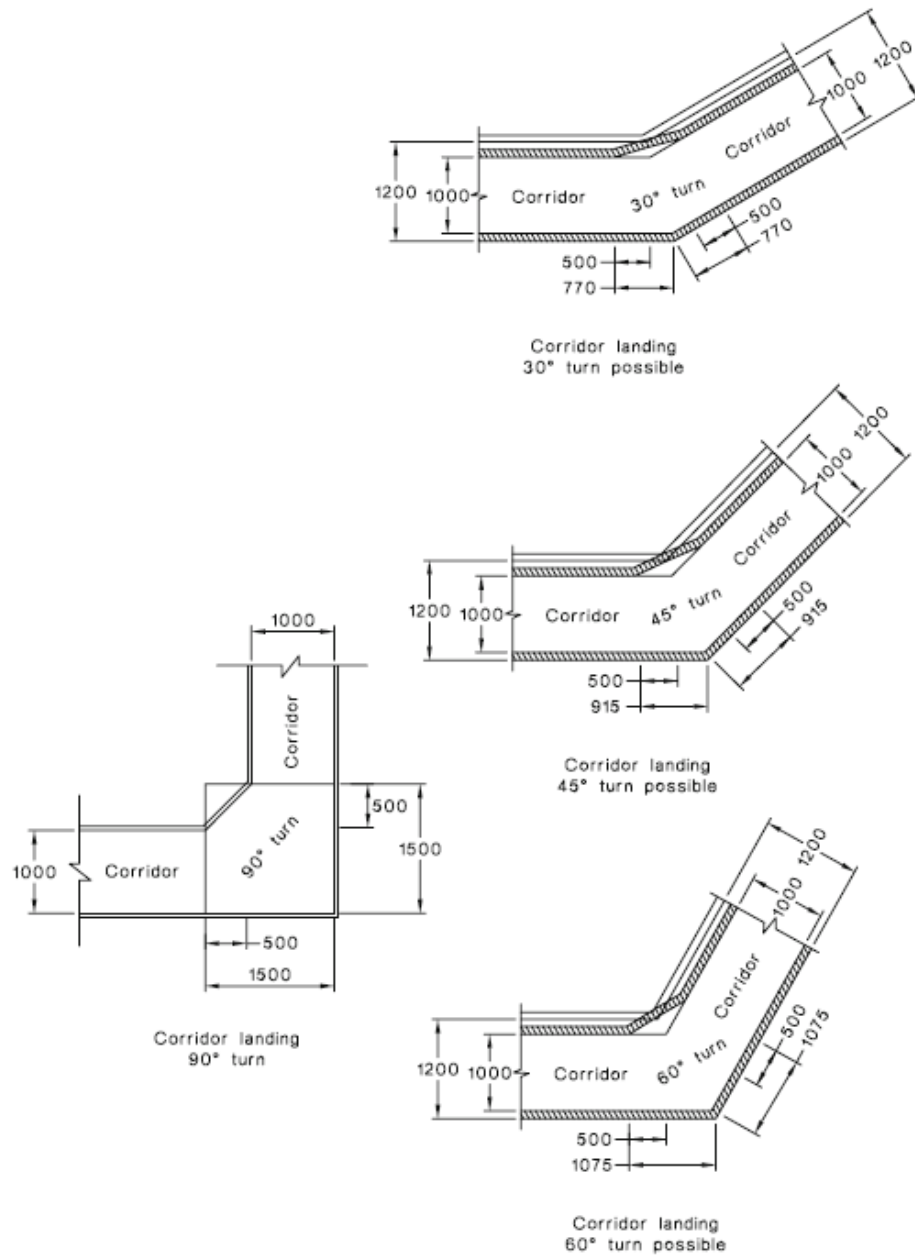

Figure 25

SAI Global Ltd License 1704-c045-2



DIMENSIONS IN MILLIMETRES

Figure 26

SAI Global Ltd License 1704-c045-2

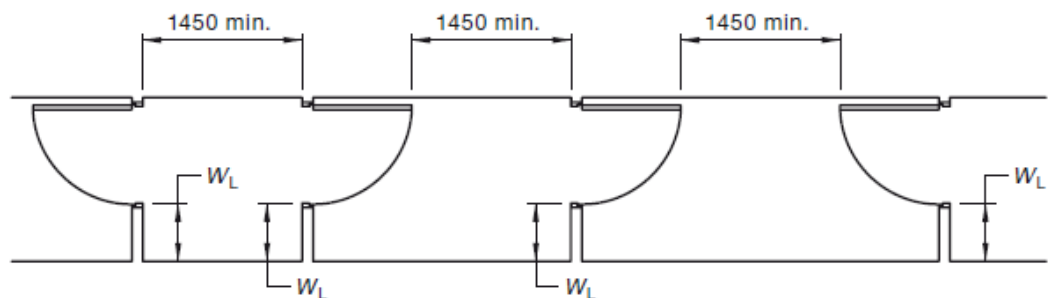

(a) Continuous accessible path of travel

DIMENSIONS IN MILLIMETRES

Figure 27

SAI Global Ltd License 1704-c045-2

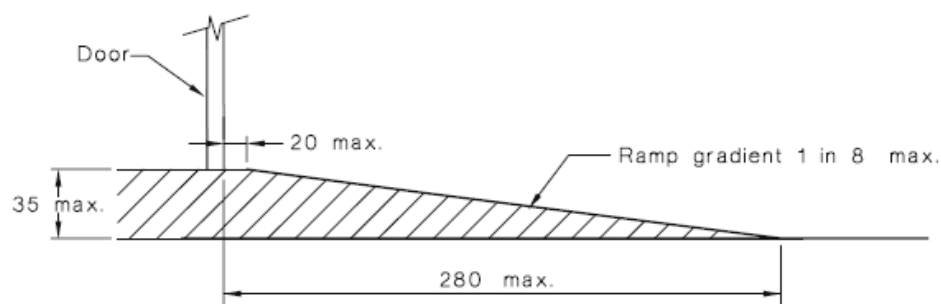

DIMENSIONS IN MILLIMETRES

Figure 28

SAI Global Ltd License 1704-c045-2

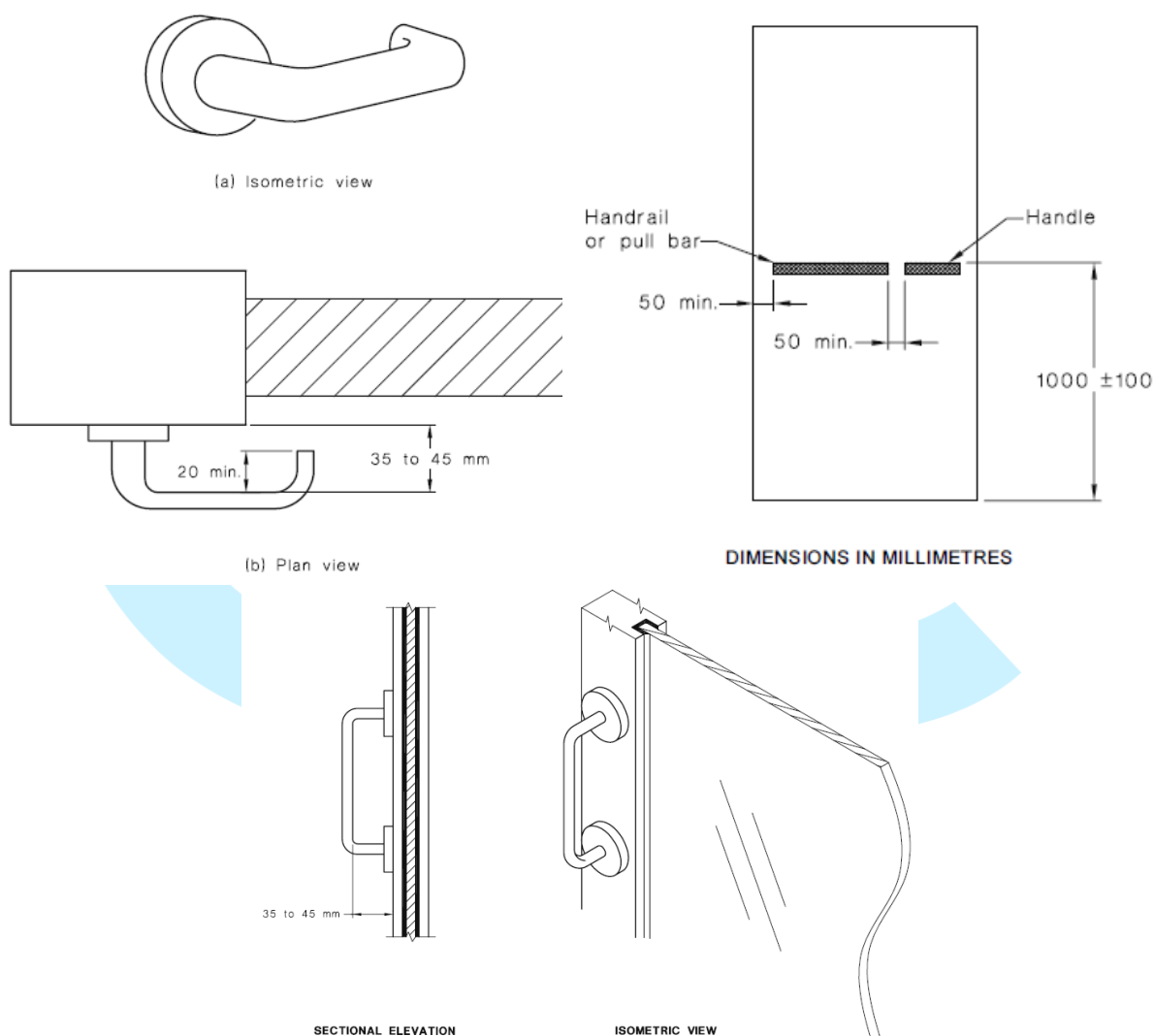

DIMENSIONS IN MILLIMETRES

SECTIONAL ELEVATION

ISOMETRIC VIEW

Figure 29

SAI Global Ltd License 1704-c045-2

4. Luminance contrast

The following applies to *luminance contrast*:

- The background, negative space, fill of a sign or border with a minimum width of 5 mm must have a *luminance contrast* with the surface on which it is mounted of not less than 30%.
- Tactile characters, icons and symbols must have a minimum *luminance contrast* of 30% to the surface on which the characters are mounted.
- Luminance contrasts* must be met under the lighting conditions in which the sign is to be located.

Figure 30

SAI Global Ltd License 1704-c045-2

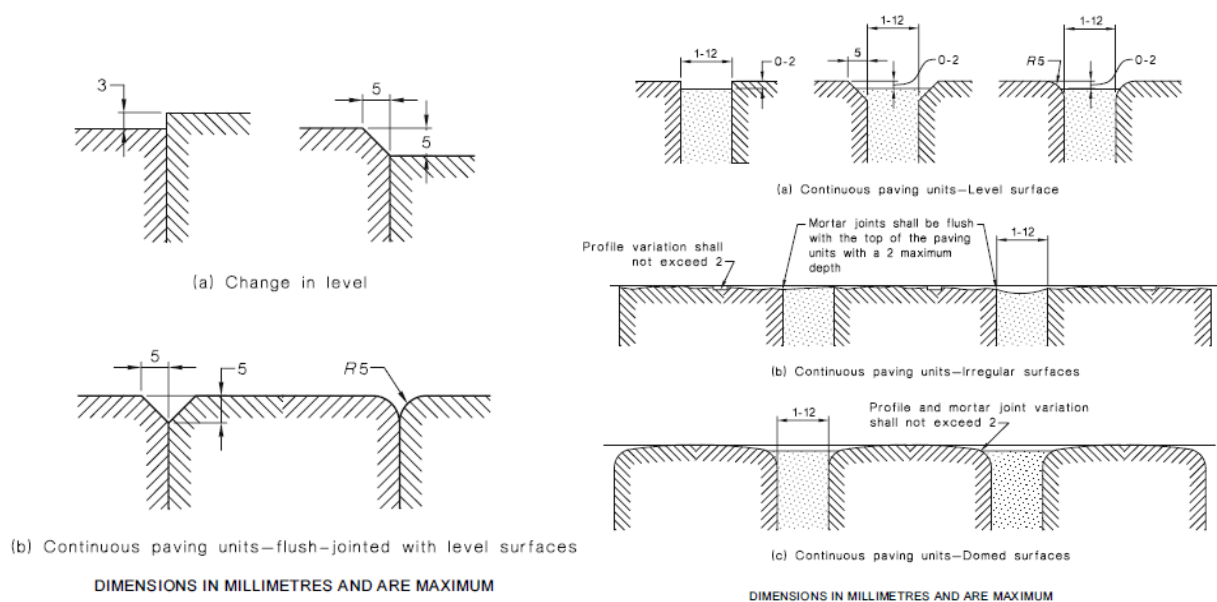

Figure 31

SAI Global Ltd License 1704-c045-2

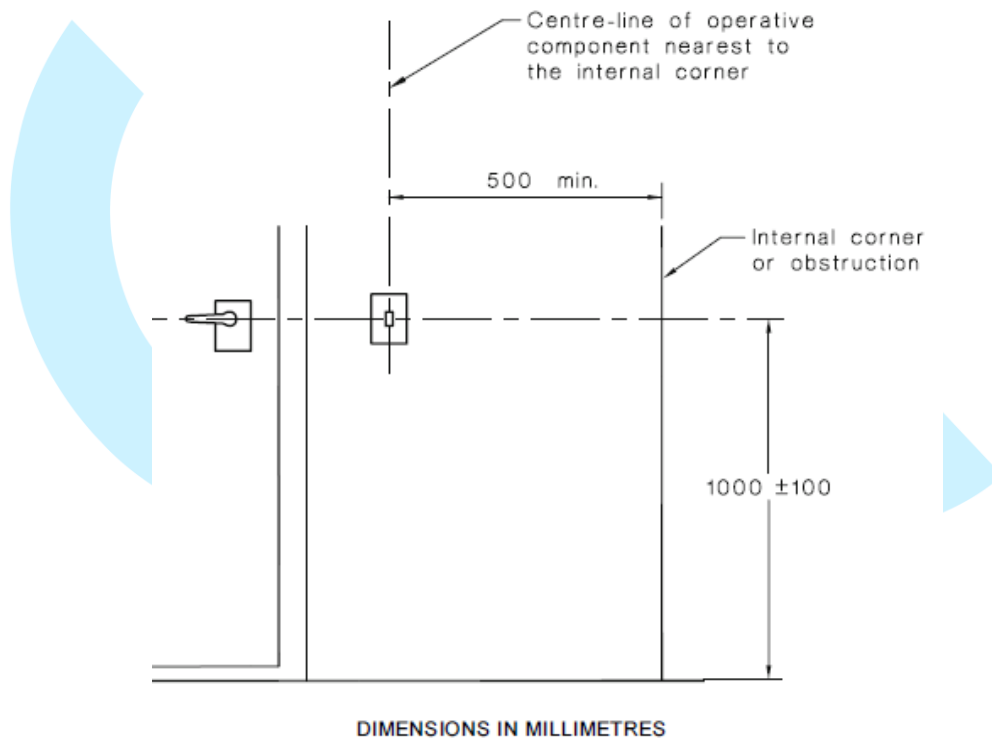

Figure 32

SAI Global Ltd License 1704-c045-2

Part E3 – Lift Installations

E3.2 Stretcher facility lifts	ADR	N/A	C
(a) a stretcher facility in accordance with (b) must be provided; <ul style="list-style-type: none"> I. In at least one emergency lift required by E3.4 II. When an emergency lift is not required, if passenger lifts are installed to serve any storey above an effective height of 12m, in at least one of those lifts to serve each floor served by the lifts Notes: Subject to BCA Consultant review and confirmation, can be compliant at CC stage & as per manufacturers specifications.	<input type="checkbox"/>	<input type="checkbox"/>	✓
(b) a stretcher facility must accommodate a raised stretcher providing a clear space not less than 600mm wide x 2000mm long x 1400mm high above the floor level Notes: Subject to BCA Consultant review and confirmation, can be compliant at CC stage & as per manufacturers specifications.	<input type="checkbox"/>	<input type="checkbox"/>	✓
E3.6 Passenger lifts	ADR	N/A	C
(a,b,c) in an accessible building every passenger lift excluding (electric passenger lift, electrohydraulic passenger lift and inclined lift) must be subject to the limitations on use specified in table E3.6a and have accessible features in accordance with table E3.6b also not rely on a constant pressure device for its operation if the lift car is fully enclosed Notes: Can be compliant at CC stage & as per manufacturers specifications.	<input type="checkbox"/>	<input type="checkbox"/>	✓
Table E3.6a Limitation on use of types of passenger lifts	ADR	N/A	C
Stairway platform lift; Must Not – <ul style="list-style-type: none"> (a) be used to serve a space in a building accommodating more than 100 persons calculated according to D1.13 (b) be used in a high traffic public use area such as a theatre, cinema, auditorium, transport interchange, shopping centre or the like (c) be used where it is possible to install another type of passenger lift (d) connect more than 2 storeys (e) where more than 1 stairway lift is installed, serve more than 2 consecutive storeys (f) when in the folded position, encroach on the minimum width of stairway required by D1.6 	<input type="checkbox"/>	✓	<input type="checkbox"/>
Low-rise platform lift; Must not travel more than 1000mm	<input type="checkbox"/>	✓	<input type="checkbox"/>
Low-rise, low-speed constant pressure lift; Must not – <ul style="list-style-type: none"> (a) for an enclosed type travel more than 4m (b) for an unenclosed type, travel more than 2m (c) be used in high traffic public use areas in buildings such as a theatre, cinema, auditorium, transport interchange, shopping complex or the like 	<input type="checkbox"/>	✓	<input type="checkbox"/>
Small sized, low-speed automatic lift; Must not travel more than 12m	<input type="checkbox"/>	✓	<input type="checkbox"/>
Table E3.6b Application of features to passenger lifts	ADR	N/A	C
All lifts except “stair platform lift” and “low-rise platform lift” have handrails complying with the provisions for a mandatory handrail in AS1735.12 Notes: Can be compliant at CC stage & as per manufacturers specifications.	<input type="checkbox"/>	<input type="checkbox"/>	✓
All lifts which travel more than 12m to have lift floor dimension of not less than 1400mm wide x 1600mm deep Notes: Can be compliant at CC stage & as per manufacturers specifications.	<input type="checkbox"/>	<input type="checkbox"/>	✓
All lifts which travel not more than 12m “excluding stairway platform lift” to have lift floor dimension of not less than 1100mm wide x 1400mm deep	<input type="checkbox"/>	✓	<input type="checkbox"/>

Floor dimension for a stairway platform lift of not less than 810 mm wide x 1200 mm deep	<input type="checkbox"/>	<input checked="" type="checkbox"/>	<input type="checkbox"/>
Minimum door opening complying with AS 1735.12 for All lifts except a stairway platform lift Notes: Can be compliant at CC stage & as per manufacturers specifications.	<input type="checkbox"/>	<input type="checkbox"/>	<input checked="" type="checkbox"/>
Passenger protection system complying with AS 1735.12 for all lifts with a power operated door Notes: Can be compliant at CC stage & as per manufacturers specifications.	<input type="checkbox"/>	<input type="checkbox"/>	<input checked="" type="checkbox"/>
Lift landing doors at the upper landing to be provided for All lifts except "stairway platform lift" Notes: Can be compliant at CC stage & as per manufacturers specifications.	<input type="checkbox"/>	<input type="checkbox"/>	<input checked="" type="checkbox"/>
Lift car and landing control buttons to comply with AS 1735.12 for All lifts except a "stairway platform lift" and "low-rise platform lift" Notes: Can be compliant at CC stage & as per manufacturers specifications.	<input type="checkbox"/>	<input type="checkbox"/>	<input checked="" type="checkbox"/>
Lighting in accordance with AS 1735.12 for all enclosed lift cars Notes: Can be compliant at CC stage & as per manufacturers specifications.	<input type="checkbox"/>	<input type="checkbox"/>	<input checked="" type="checkbox"/>
All lifts servicing more than 2 levels; (a) Automatic audible information within the lift car to identify the level each time the car stops, and (b) Audible and visual indication at each lift landing to indicate the arrival of the lift car, and (c) Audible information and audible indication required by (z) and (b) is to be provided in a range of between 20-80 dB(A) at a maximum frequency of 1500 Hz Notes: Can be compliant at CC stage & as per manufacturers specifications.	<input type="checkbox"/>	<input type="checkbox"/>	<input checked="" type="checkbox"/>
All lifts except "stairway platform lift" to have an emergency hands-free communication, including a button that alerts a call centre of a problem and a light to signal that the call has been received Notes: Can be compliant at CC stage & as per manufacturers specifications.	<input type="checkbox"/>	<input type="checkbox"/>	<input checked="" type="checkbox"/>

Part F2 – References

The references below to be read as set and referenced in each section of part F2



Figure 33

SAI Global Ltd License 1704-c045-2

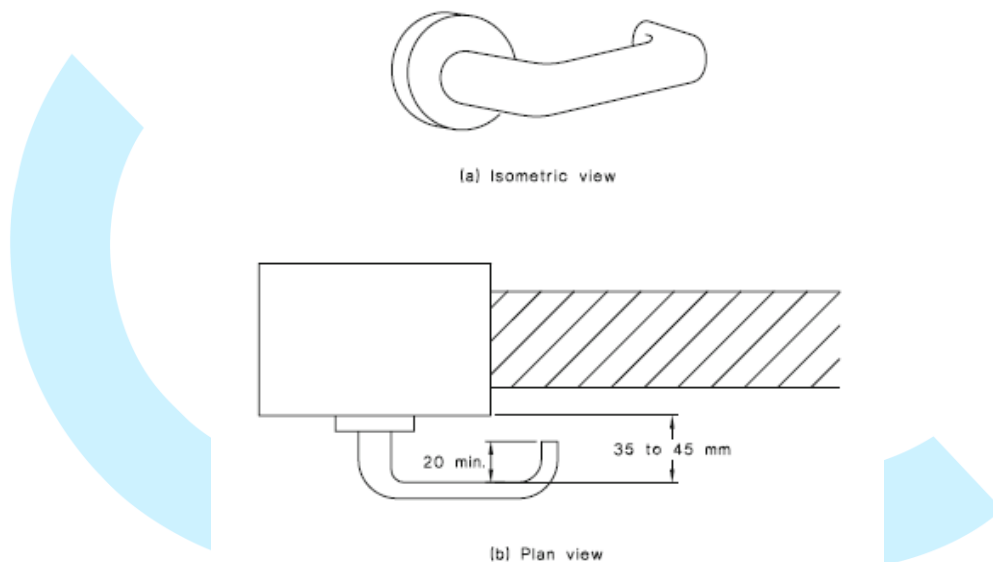

FIGURE 35(A) EXAMPLE OF ACCEPTABLE DOOR HARDWARE FOR HINGED DOORS

Figure 34

SAI Global Ltd License 1704-c045-2

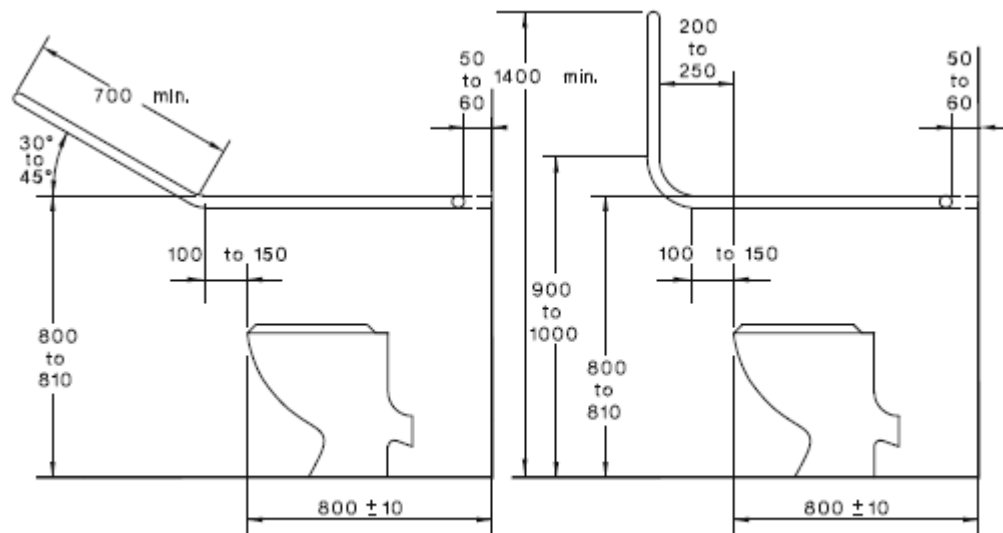

Figure 35

SAI Global Ltd License 1704-c045-2

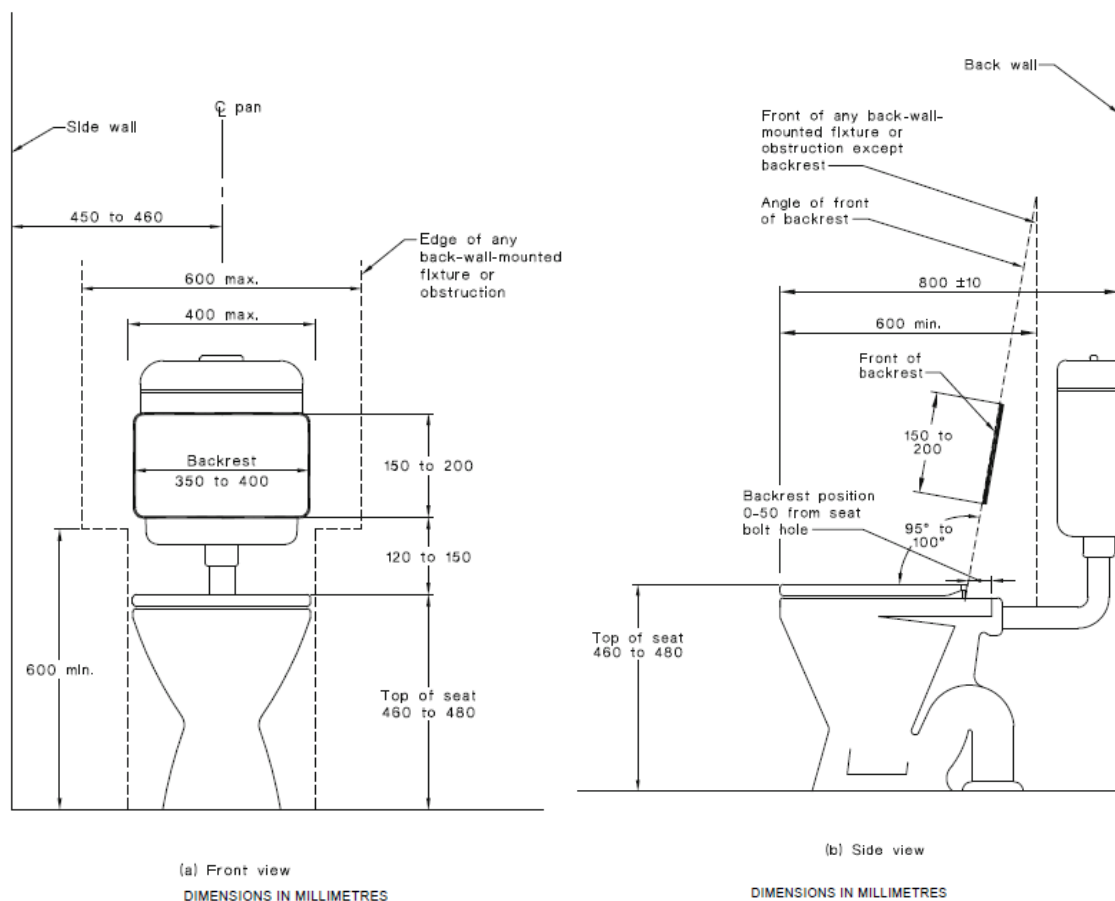

Figure 36

SAI Global Ltd License 1704-c045-2

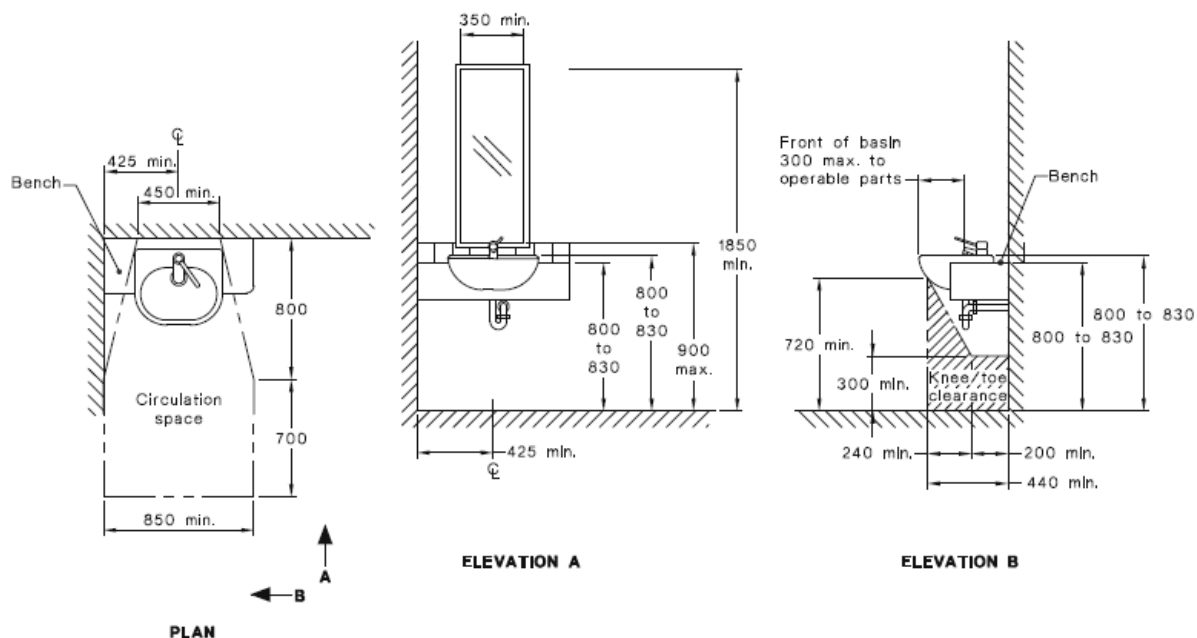

Figure 37

SAI Global Ltd License 1704-c045-2

15.4 Fixtures and fittings within a sanitary facility

15.4.1 Mirrors

In all sanitary facilities, the mirror shall be located either above or adjacent to the washbasin.

Where provided, a vertical mirror with a reflective surface not less than 350 mm wide shall extend from a height of not more than 900 mm to a height of not less than 1850 mm above the plane of the finished floor. Where provided, a second vertical mirror shall extend from a height of not less than 600 mm to a height of not less than 1850 mm above the plane of the finished floor.

NOTE: Angled or tilted mirrors should not be used since they do not work for all users or accessible facilities.

In an accessible sole occupancy unit, the mirror shall be centred over the washbasin.

15.4.2 Shelves

Shelf space shall be provided adjacent to the washbasin in one of the following ways:

- As a vanity top at a height of 800 mm to 830 mm and a minimum width of 120 mm and depth of 300 mm to 400 mm without encroaching into any circulation space.
- As a separate fixture—
 - within any circulation space at a height of 900 mm to 1000 mm with a width of 120 mm to 150 mm and length of 300 mm to 400 mm; and
 - external to all circulation spaces at a height of 790 mm to 1000 mm with a minimum width of 120 mm and minimum length of 400 mm.

15.4.3 Soap dispensers, towel dispensers and similar fittings

Where provided, soap dispensers, towel dispensers, hand dryers and similar fittings shall be operable by one hand, and shall be installed with the height of their operative component or outlet not less than 900 mm and not more than 1100 mm above the plane of the finished floor, and no closer than 500 mm from an internal corner.

15.4.4 Clothes-hanging devices

A clothes-hanging device shall be installed 1200 mm to 1350 mm above the plane of the finished floor and not less than 500 mm out from any internal corner.

15.4.5 Sanitary disposal unit

Where provided, the sanitary disposal unit shall be located as follows:

- Portable unit as shown in Figure 43.
- Recessed unit within 500 mm from the pan.

15.4.6 Switches and general purpose outlets

Where provided near the washbasin, switches and general purpose outlets shall be located in accordance with Clause 14 and as close to the shelf or worktop as practicable.

Figure 38

SAI Global Ltd License 1704-c045-2

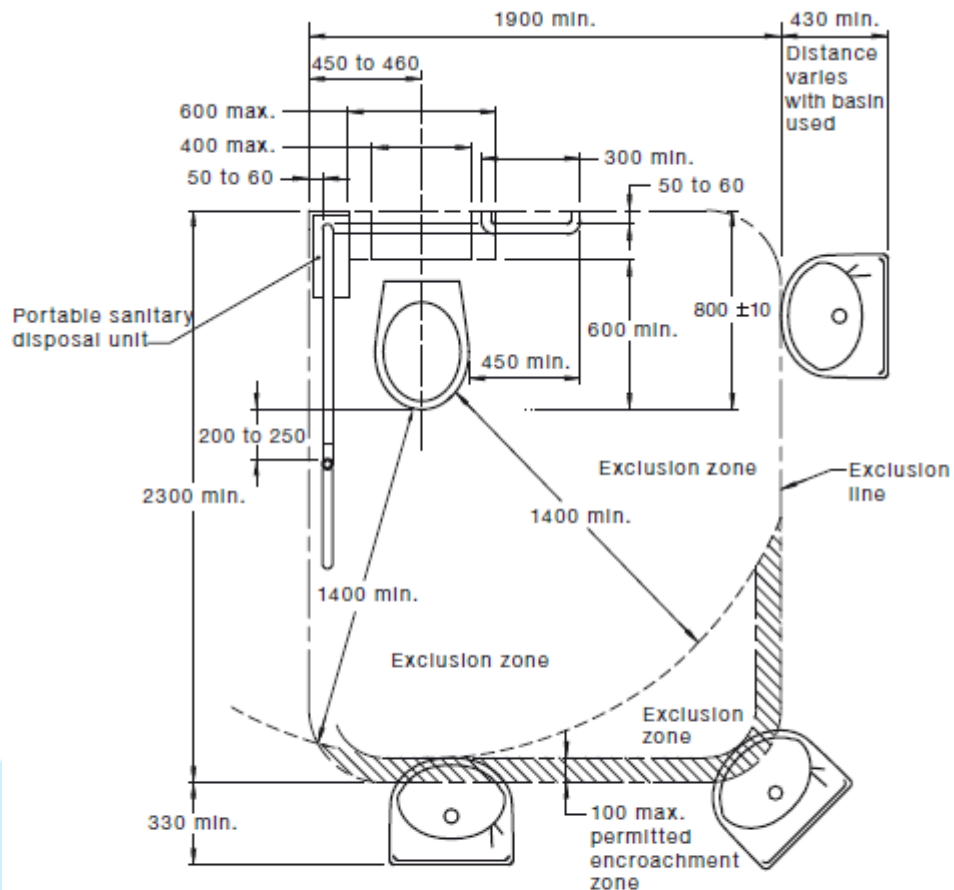

LEGEND

— — — Circulation space line

NOTE: This circulation space may overlap any other circulation spaces specified in this Standard.

DIMENSIONS IN MILLIMETRES

Figure 39

SAI Global Ltd License 1704-c045-2

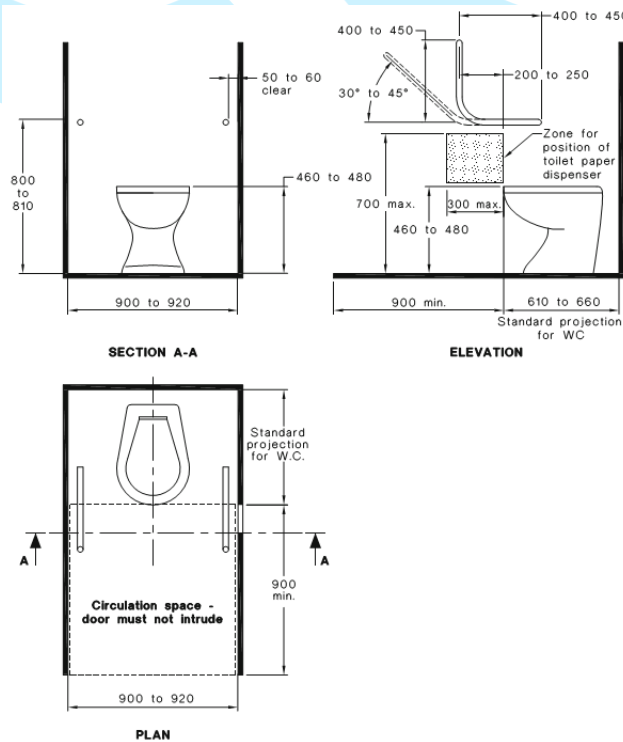

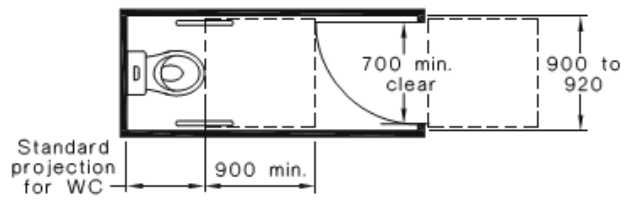

(a)

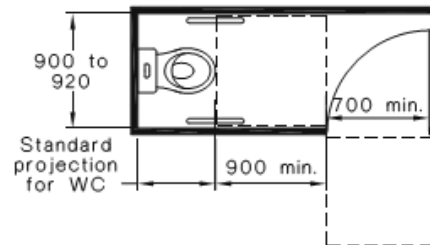

(b)

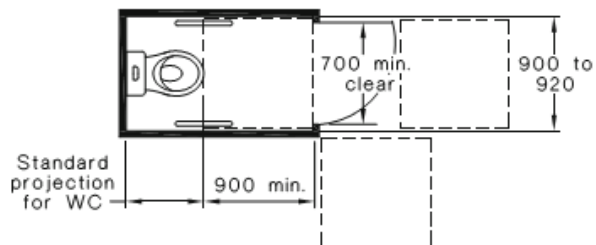

(c)

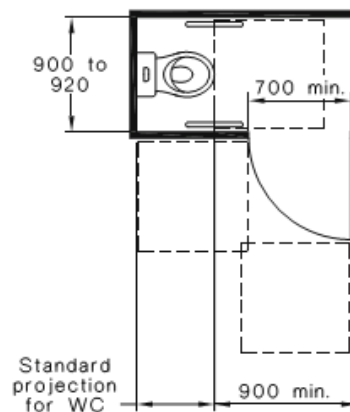

(d)

LEGEND:



900 x 900 circulation space

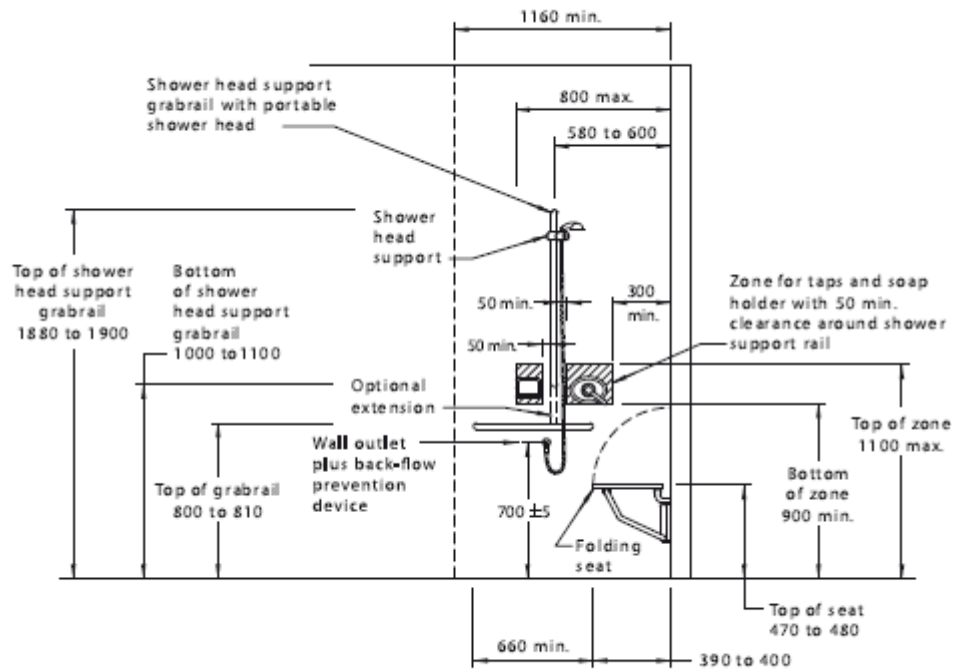

DIMENSIONS IN MILLIMETRES

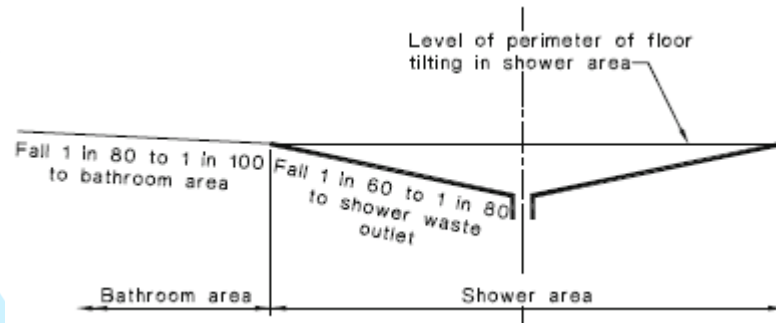

Figure 40

SAI Global Ltd License 1704-c045-2

AS 4299 – 1995 Adaptable Housing Requirements

This schedule is a list of essential features to be incorporated into a housing unit for it to be termed an 'Adaptable House'. **29 Adaptable units** are required as per Penrith Councils DCP (10% of total amount).

The units must achieve **Class C** compliance as per AS4299 Checklist below where all essential features are incorporated. Some requirements are achieved at post adaptation where noted.

Units **A203, A303, B202, B302, B402, B502, B602, B702, B802, B902, C203, D202, D203, D302, D303, D402, D403, D502, D503, D602, D603, D702, D703, D802, D803, D902, D903, E202 & E302.** have been chosen as "Adaptable units"

R = Required

C = Capable of Compliance by adding the requirement to the project specifications or at post adaption stage.

Item No.	Clause No.	Requirements as per AS4299	R	C	Comments
DRAWINGS					
1	2.3	Provision of drawings showing the housing unit in its pre-adaption and post-adaption stages.	✓	✓	Can be compliant at post adaptation
SITING					
3	3.3.2	A continuous accessible path of travel from street frontage and vehicle parking to entry complying with AS 1428.1	✓	✓	Complies.
LETTER BOXES IN ESTATE DEVELOPMENTS					
11	3.8	Letterboxes to be on hard standing area connected to accessible pathway	✓	✓	Letterboxes for adaptable units to be at a height of 900-1100mm above FFL
PRIVATE CAR ACCOMODATION					
14	3.7.2	Car parking space or garage min. area 6.0 m × 3.8 m	✓	✓	Parking spaces being provided in accordance with AS4299
ACCESSIBLE ENTRY					
20	4.3.1	Accessible entry	✓	✓	Can be compliant at post adaptation
22	4.3.2	Accessible entry to be level (i.e. max. 1:40 slope)	✓	✓	Can be compliant at post adaptation
23	4.3.2	Threshold to be low-level	✓	✓	Can be compliant at post adaptation
24	4.3.2	Landing to enable wheelchair manoeuvrability	✓	✓	Can be compliant at post adaptation
25	4.3.1	Accessible entry door to have 850 mm min. clearance	✓	✓	Can be compliant at post adaptation
27	4.3.4	Door lever handles and hardware to AS 1428.1	✓	✓	Can be compliant at post adaptation
INTERIOR GENERAL					
32	4.3.3	Internal doors to have 820 mm min. clearance	✓	✓	Can be compliant at post adaptation
33	4.3.7	Internal corridors min. width of 1000 mm	✓	✓	
34	4.3.7	Provision for compliance with AS 1428.1 for door approaches	✓	✓	Can be compliant at post adaptation
LIVING ROOM & DINING ROOM					
36	4.7.1	Provision for circulation space of min. 2250 mm diameter	✓	✓	Can be compliant at post adaptation
38	4.7.4	Telephone adjacent to GPO	✓	✓	Notes on plans
41	4.10	Potential illumination level min. 300 lux	✓	✓	Notes on plans
KITCHEN					
42	4.5.2	Minimum width 2.7 m (1550 mm clear between benches)	✓	✓	Can be compliant at post adaptation
43	4.5.1	Provision for circulation at doors to	✓	✓	Can be compliant at post adaptation

		comply with AS 1428.1			
44	4.5.5	Provision for benches planned to include at least one work surface of 800 mm length, adjustable in height from 750 mm to 850 mm or replaceable. Refer to Figure 4.8	✓	✓	Can be compliant at post adaptation
45	4.5.5	Refrigerator adjacent to work surface	✓	✓	Can be compliant at post adaptation
46	4.5.6	Kitchen sink adjustable to heights from 750 mm to 850 mm or replaceable	✓	✓	Can be compliant at post adaptation
47	4.5.6	Kitchen sink bowl max. 150 mm deep	✓	✓	Can be compliant at post adaptation
48	4.5.6 e	Tap set capstan or lever handles or lever mixer	✓	✓	Can be compliant at post adaptation
49	4.5.6 e	Tap set located within 300 mm of front of sink	✓	✓	Can be compliant at post adaptation
51	4.5.7	Cooktops to include either front or side controls with raised cross bars	✓	✓	Can be compliant at post adaptation
52	4.5.7	Cooktops to include isolating switch	✓	✓	Can be compliant at post adaptation
53	4.5.7	Work surface min. 800 mm length adjacent to cooktop at same height	✓	✓	Can be compliant at post adaptation
54	4.5.8	Oven located adjacent to an adjustable height or replaceable work surface	✓	✓	Can be compliant at post adaptation
59	4.5.11	GPOs to comply with AS 1428.1. At least one double GPO within 300 mm of front of work surface	✓	✓	Can be compliant at post adaptation
60	4.5.11	GPO for refrigerator to be easily reachable when the refrigerator is in its operating position	✓	✓	Can be compliant at post adaptation
61	4.5.4	Slip-resistant floor surface	✓	✓	Can be compliant at post adaptation
MAIN BEDROOM					
62	4.6.1	At least one bedroom of area sufficient to accommodate queen size bed and wardrobe and circulation space requirements of AS 1428.2	✓	✓	Can be compliant at post adaptation
BATHROOM					
75	4.4.1	Provision for bathroom area to comply with AS 1428.1	✓	✓	A bathroom with the minimum dimension of 2.05x2.95m or 2.3x2.7m or 2.4x2.45m
76	4.4.2	Slip-resistant floor surface	✓	✓	Can be compliant at post adaptation
77	4.4.4f	Shower recess- no hob. Minimum size 1160 × 1100 to comply with AS 1428.1. (Refer Figures 4.6 and 4.7)	✓	✓	Can be compliant at post adaptation
78	4.4.4f	Shower area waterproofed to AS 3740 with floor to fall to waste	✓	✓	Can be compliant at post adaptation
79	4.4.4f	Recessed soap holder	✓	✓	Can be compliant at post adaptation
80	4.4.4f	Shower taps positioned for easy reach to access side of shower sliding track	✓	✓	Can be compliant at post adaptation
82	4.4.4h	Provision for adjustable, detachable hand held shower rose mounted on a slider grab rail or fixed hook	✓	✓	Can be compliant at post adaptation
83	4.4.4h	Provision for grab rail in shower (Refer to Figure 4.7) to comply with AS 1428.1	✓	✓	Can be compliant at post adaptation
86	4.4.4c	Tap sets to be capstan or lever handles with single outlet	✓	✓	Can be compliant at post adaptation
88	4.4.4g	Provision for washbasin with clearances to comply with AS 1428.1	✓	✓	Can be compliant at post adaptation
90	4.4.4d	Double GPO beside mirror 4.4.4(d)	✓	✓	Can be compliant at post adaptation
TOILET					
92	4.4.3	Provision of either 'visitable toilet' or accessible toilet	✓	✓	Can be compliant at post adaptation
93	4.4.1	Provision to comply with AS 1428.1	✓	✓	Can be compliant at post adaptation
94	4.4.3	Location of WC pan at correct distance from fixed walls	✓	✓	Can be compliant at post adaptation
95	4.4.4b	Provision for grab rail zone.	✓	✓	Can be compliant at post adaptation

		(Refer Figure 4.6)			
96	4.4.2	Slip resistant floor surface. (Vitreous tiles or similar)	✓	✓	Can be compliant at post adaptation
LAUNDRY					
98	4.8	Circulation at doors to comply with AS 1428.1	✓	✓	Can be compliant at post adaptation
99	4.8	Provision for adequate circulation space in front of or beside appliances (min. 1550 mm depth)	✓	✓	Can be compliant at post adaptation
100	4.8 e	Provision for automatic washing machine	✓	✓	Can be compliant at post adaptation
102	4.8a	Where clothes line is provided, an accessible path of travel to this	✓	✓	
105	4.8 g	Double GPO	✓	✓	Can be compliant at post adaptation
108	4.9.1	Slip-resistant floor surface	✓	✓	Can be compliant at post adaptation
DOORLOCKS					
110	4.3.4	Door hardware operable with one hand, located 900–1100 mm above floor	✓	✓	Can be compliant at post adaptation
FLOOR COVERINGS					
111	4.9.4	Slip resistant surfaces – balconies and all external paved areas	✓	✓	Can be compliant at CC stage
ANCILLARY ITEMS					
112	4.11.1	Switches located 900-1100mm above floor in line with door handles	✓	✓	Can be compliant at CC stage
113	4.11.1	GPOs located not less than 600mm above floor	✓	✓	Can be compliant at CC stage
114	4.11.2	Electrical distribution board located inside housing unit.	✓	✓	Can be compliant at CC stage
GARBAGE					
116	4.11.6	Provision for bin in accessible location	✓	✓	Can be compliant at CC stage

REQUIREMENT

- Where the location of fixtures such as WC pan, wash basin, sink, shower, laundry fixtures, and any other fixtures are to be relocated at post-adaptation, **All** services pipes (both water and waste supply pipes) have to be laid in accordance with AS 1428.1 and in its specified location at “Post-Adaptation” where all services to be capped-off for future use.

GENERAL RECOMMENDATIONS (ADVISORY ONLY AND NOT MANDATORY)

- Private balconies and outdoor areas provided to the Adaptable units to have recessed sliding doors tracks so level access is provided between the balcony/outdoor area and the internal spaces.
- Sliding or/and Hinged doors leading to private balconies and/or outdoor areas provided to the Adaptable units to have a clear door opening of 850mm with side latch clearance of 530mm
- Consideration to the finishes and method of construction to the wet areas so that flush transition is achieved between the wet area floor and the external/corridor finishes.
- For new kitchen/s in residential development, it is recommended that the kitchen could be made partially accessible by providing a width of 900mm next to the sink as vacant space without the cabinetry under the bench top and a long lever tap with spout handle within 300mm from the edge of the front benchtop. The distance in between benches to achieve 1550mm, in addition to 1x DGPO to be provided within 300mm from the edge of the benchtop.



Figure 43

SAI Global Ltd License 1704-c045-2

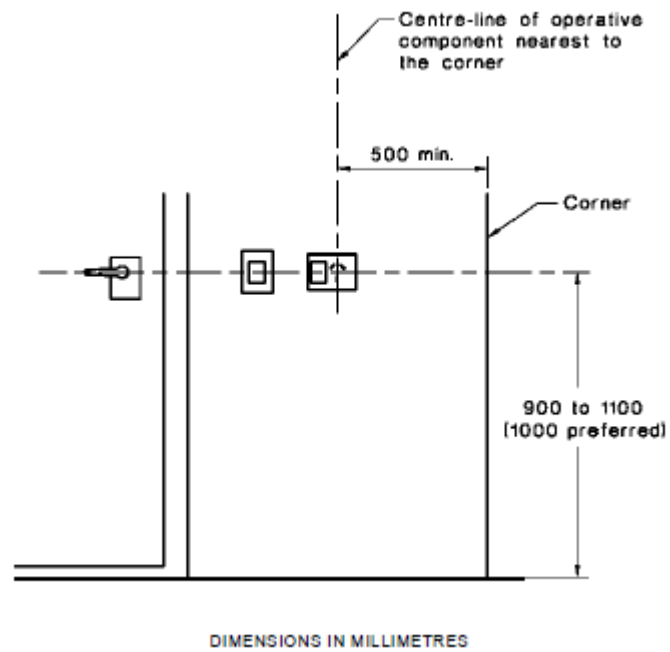

Figure 44

SAI Global Ltd License 1704-c045-2



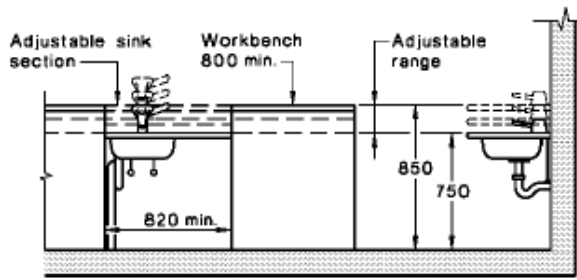
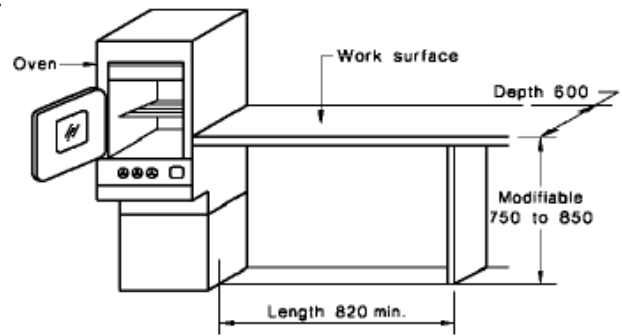

FIGURE 4.9 SINKS AFTER MODIFICATION

Figure 39



DIMENSIONS IN MILLIMETRES

SAI Global Ltd License 1704-c045-2

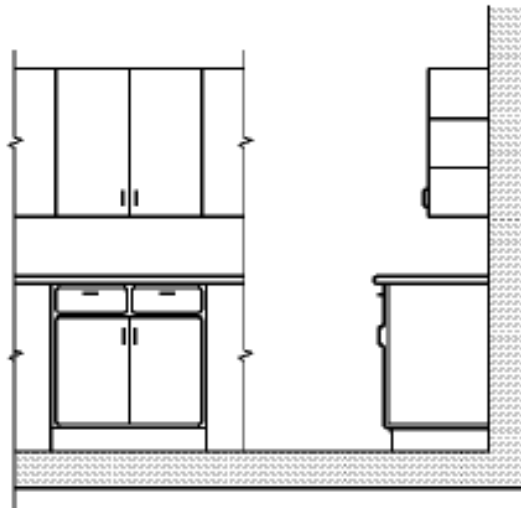

(a) Before removal of cabinets

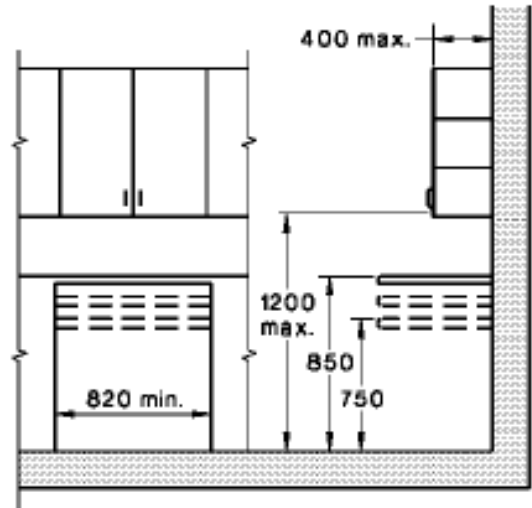

(b) After removal of cabinets

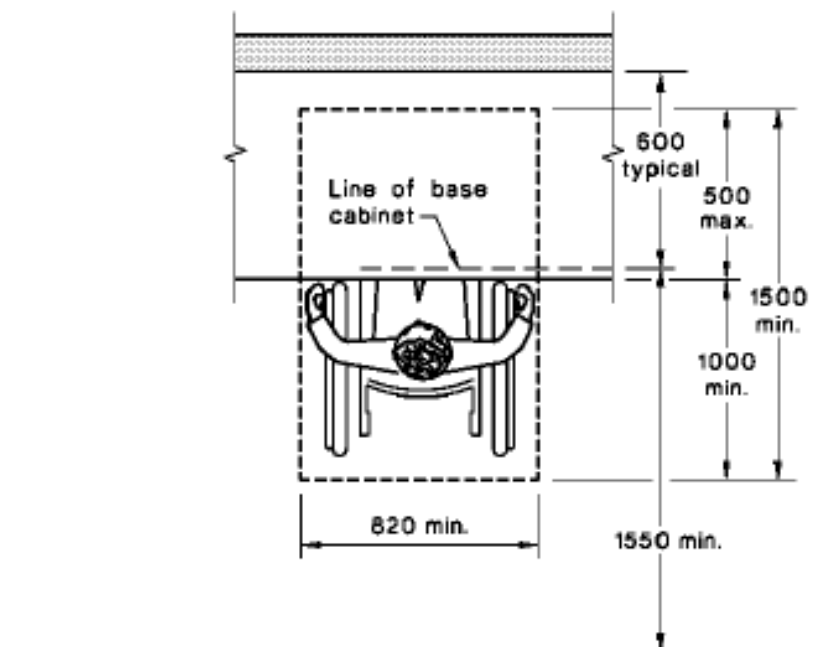

(c) Clear floor space under work surface

Figure 45

SAI Global Ltd License 1704-c045-2

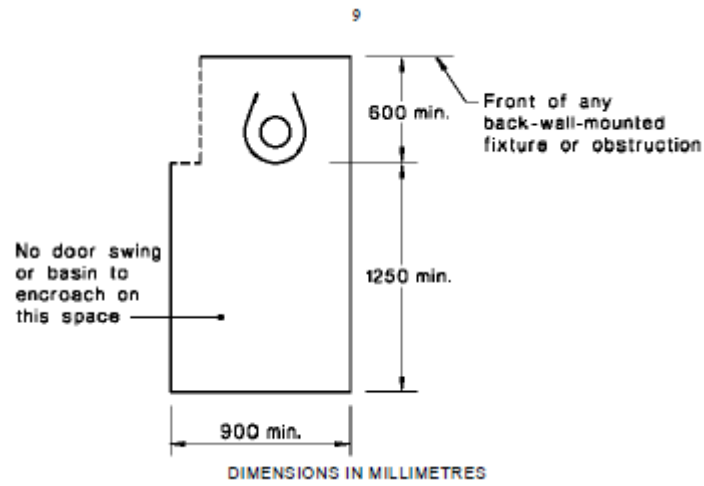

Figure 46

SAI Global Ltd License 1704-c045-2

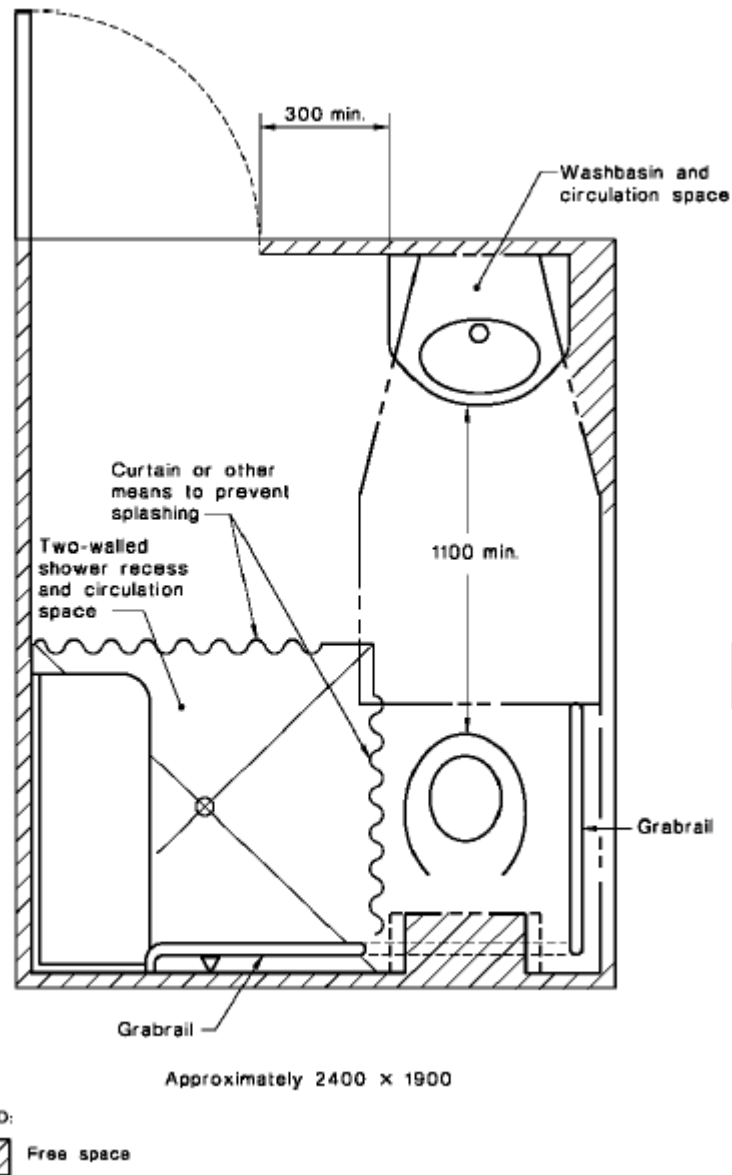
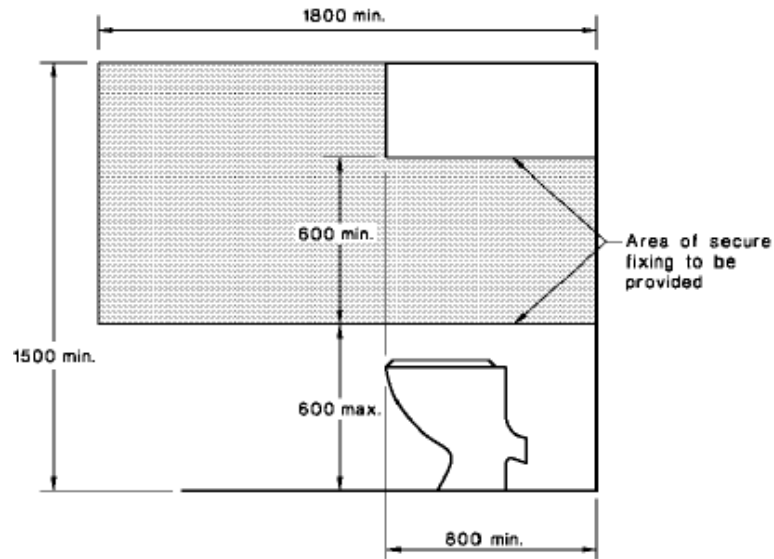
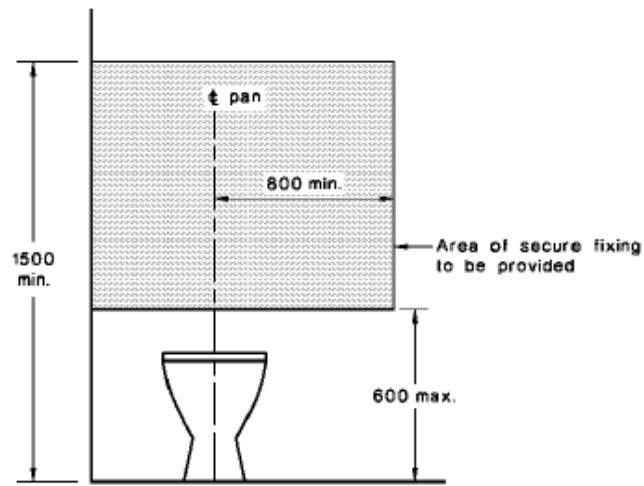

Figure 47

SAI Global Ltd License 1704-c045-2



(a) Side view



(b) Front view

DIMENSIONS IN MILLIMETRES

FIGURE 4.5 REINFORCED AREAS FOR SUBSEQUENT INSTALLATION OF GRABRAILS IN TOILETS

Figure 48

SAI Global Ltd License 1704-c045-2

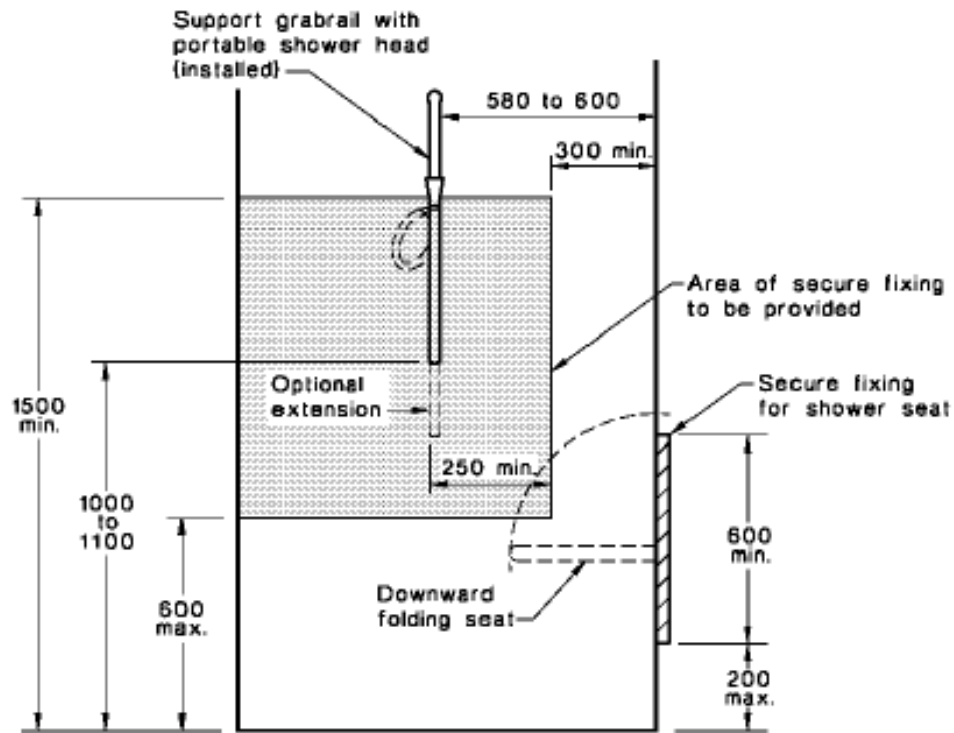

(a) Back wall

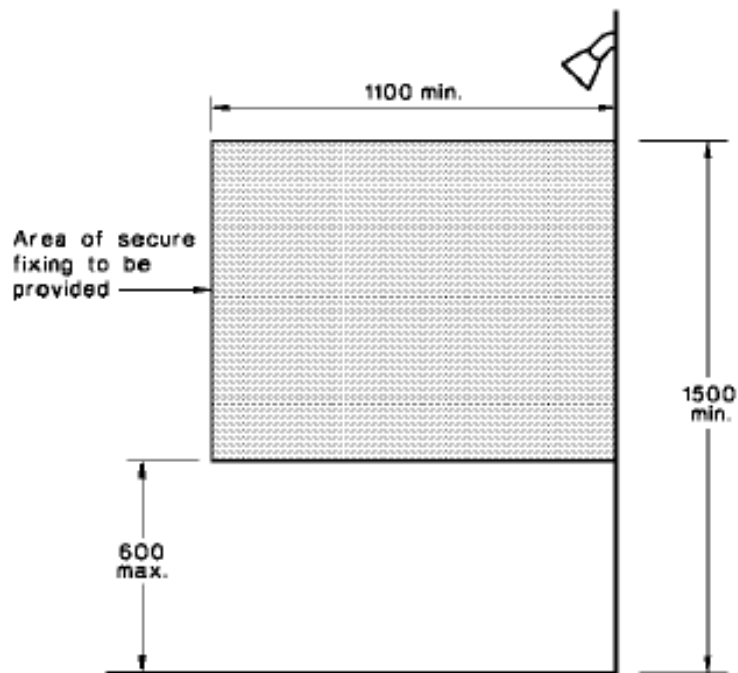

(b) Side wall

DIMENSIONS IN MILLIMETRES

Figure 49

SAI Global Ltd License 1704-c045-2

The attachments below are extracted from the Architectural Plans provided and are to be read together with AS 4299 Adaptable Housing Requirements.

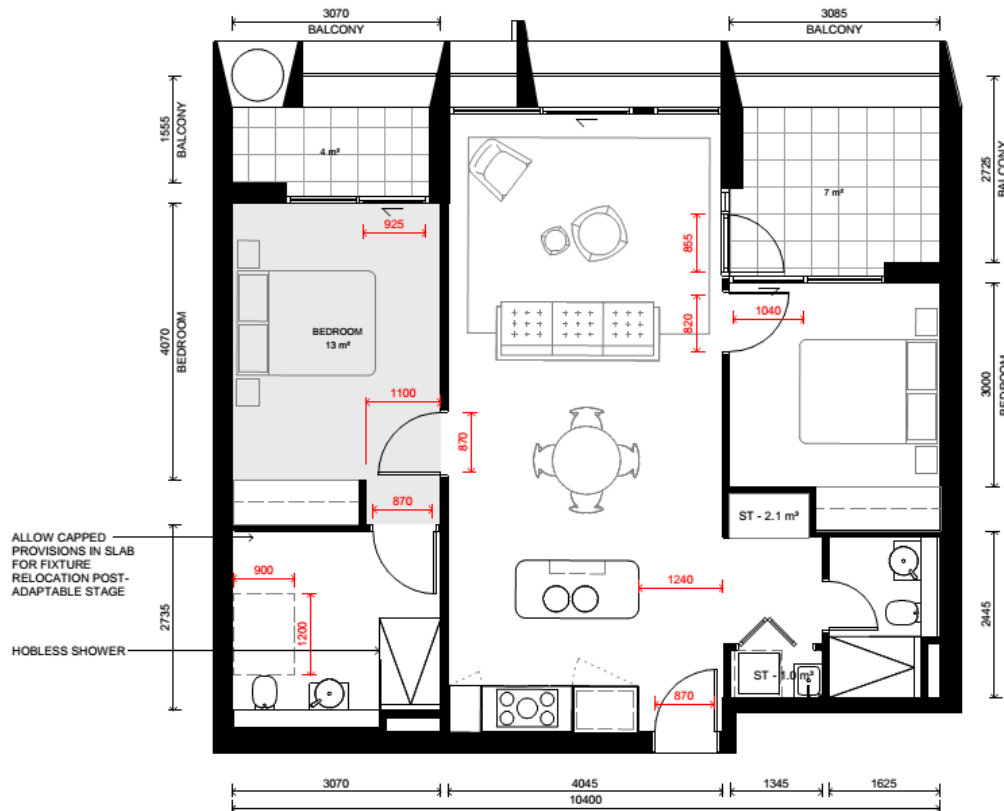

Pre-Adaptable Units A203, A303, B202, B302, B402, B502, B602, B702, B802, B902, C203, D202, D203, D302, D303, D402, D403, D502, D503, D602, D603, D702, D703, D802, D803, D902, D903, E202 & E302

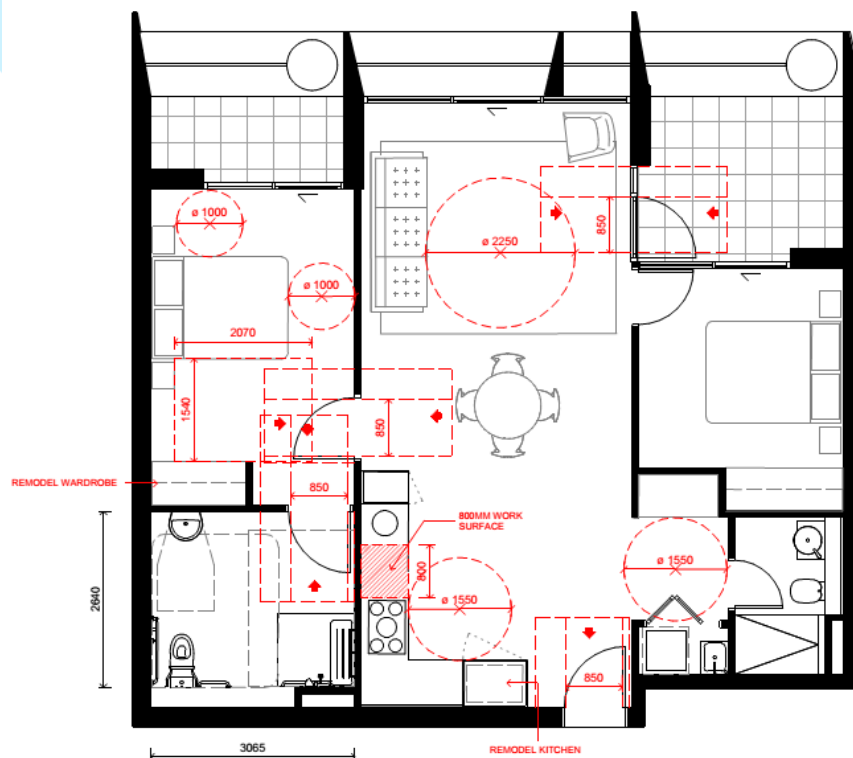

Post Adaptable Units A203, A303, B202, B302, B402, B502, B602, B702, B802, B902, C203, D202, D203, D302, D303, D402, D403, D502, D503, D602, D603, D702, D703, D802, D803, D902, D903, E202 & E302

SEPP 65 – Part 4Q1 Livable Housing Guidelines

As per SEPP 65, 20% of the units are to be designed as 'Livable'. The development proposes 287 Units which require 58 Units to be designed as 'Livable', however 60 have been provided. 29 adaptable units have already been provided and can be used as Livable at both Pre and Post adaptable stages, being units A203, A303, B202, B302, B402, B502, B602, B702, B802, B902, C203, D202, D203, D302, D303, D402, D403, D502, D503, D602, D603, D702, D703, D802, D803, D902, D903, E202 & E302. The remainder of the livable units are A203, A212, A213, A303, A312, A313, A412, A413, A512, A513, A612, A613, A712, A713, A812, A813, A912, A913, B202, B205, B302, B306, B402, B406, B502, B506, B602, B606, B702, B706, B802, B806, B906, D306, D406, D506, D606, D706, D806 & D906.

1. A safe continuous and step free path of travel from the street entrance and/ or parking area to a dwelling entrance that is level	ADR	N/A	C
<p>a. Provide a safe and continuous pathway from:</p> <ul style="list-style-type: none"> I. the front boundary of the allotment; or II. a car parking space, where provided, which may include the driveway on the allotment, to an entrance that is level (step-free) <p>This provision does not apply where the average slope of the ground where the path would feature is steeper than 1:14. Notes: See Att. 02 – Can be compliant at CC stage</p>	<input type="checkbox"/> <input type="checkbox"/>	<input type="checkbox"/> <input checked="" type="checkbox"/>	<input checked="" type="checkbox"/> <input type="checkbox"/>
<p>b. The path of travel as referred to in (a) should have a minimum clear width of 1000mm and –</p> <ul style="list-style-type: none"> I. an even, firm, slip resistant surface; II. a cross fall of not more than 1:40; III. A maximum pathway slope of 1:14, with landings provided at no greater than 9m for a 1:14 ramp and no greater than 15m for ramps steeper than 1:20. Landings should be no less than 200mm in length; and IV. be step-free 	<input type="checkbox"/>	<input type="checkbox"/>	<input checked="" type="checkbox"/>
<p>c. A step ramp may be incorporated at an entrance doorway where there is a change in height of 190mm or less. The step ramp should provide:</p> <ul style="list-style-type: none"> I. a maximum gradient of 1:10 II. a minimum clear width of 1000mm (please note: width should reflect the pathway width) III. a maximum length of 1900mm <p>Level landings no less than 1200mm in length, exclusive of the swing of the door or gate than opens onto them, must be provided at the head and foot of the ramp.</p>	<input type="checkbox"/>	<input type="checkbox"/>	<input checked="" type="checkbox"/>
2. At least one, level (Step free) entrance into the dwelling			
<p>a. The dwelling should provide an entrance door with –</p> <ul style="list-style-type: none"> I. a minimum clear opening width of 820mm (see Figure 2(a)); II. a level (step-free) transition and threshold (maximum vertical tolerance of 5mm between abutting surfaces is allowable provided the lip is rounded or bevelled); and III. Reasonable shelter from the weather. <p>Reference: Figure 50 Notes: See Att. 02 – Can be compliant at CC stage</p>	<input type="checkbox"/>	<input type="checkbox"/>	<input checked="" type="checkbox"/>
<p>b. A level landing area of 1200mm x 1200mm should be provided at the level (step-free) entrance door.</p>	<input type="checkbox"/>	<input type="checkbox"/>	<input checked="" type="checkbox"/>
<p>c. Where the threshold at the entrance exceeds 5mm and is less than 56mm, a ramped threshold may be provided.</p>	<input type="checkbox"/>	<input type="checkbox"/>	<input checked="" type="checkbox"/>
<p>d. The level (step-free) entrance should be connected to the safe and continuous pathway.</p>	<input type="checkbox"/>	<input type="checkbox"/>	<input checked="" type="checkbox"/>

3. Internal doors and corridors that facilitate comfortable and unimpeded movement between spaces.			
<p>a. Doorways to rooms on the entry level used for living, dining, bedroom, bathroom, kitchen, laundry and sanitary compartment purposes should provide:</p> <ul style="list-style-type: none"> I. a minimum clear opening width of 820mm (see Figure 2(a)); and II. A level transition and threshold (maximum vertical tolerance of 5mm between abutting surfaces is allowable provided the lip is rounded or bevelled). <p>Reference: Figure 50 Notes: See Att. 02 – Can be compliant at CC stage</p>	<input type="checkbox"/>	<input type="checkbox"/>	✓
<p>b. Internal corridors/passageways to the doorways referred to in (a) should provide a minimum clear width of 1000mm.</p>	<input type="checkbox"/>	<input type="checkbox"/>	✓
4. A toilet on the ground (or entry) level that provides easy access.			
<p>a. Dwellings should have a toilet on the ground (or entry) level that provides:</p> <ul style="list-style-type: none"> I. a minimum clear width of 900mm between the walls of the bathroom if located in a separate room; and II. A minimum 1200mm clear circulation space forward of the toilet pan exclusive of the swing of the door in accordance with Figure 3(a). <p>Reference: Figure 51 Notes: See Att. 02 – Can be compliant at CC stage</p>	<input type="checkbox"/>	<input type="checkbox"/>	✓
<p>b. If the toilet is located within the ground (or entry) level bathroom, the toilet pan should be located in the corner of the room to enable the installation of grab rails.</p> <p>Reference: Figure 52, Figure 53 Notes: See Att. 02 – Can be compliant at CC stage</p>	<input type="checkbox"/>	<input type="checkbox"/>	✓
5. A bathroom that contains a hob-less (step-free) shower recess.			
<p>a. One bathroom should feature a slip resistant, hobless (step-free) shower recess. Shower screens are permitted provided they can be easily removed at a later date.</p>	<input type="checkbox"/>	<input type="checkbox"/>	✓
<p>b. The shower recess should be located in the corner of the room to enable the installation of grab rails at a future date.</p> <p>Reference: Figure 55 Notes: See Att. 02 – Can be compliant at CC stage</p>	<input type="checkbox"/>	<input type="checkbox"/>	✓
6. Reinforced walls around the toilet, shower and bath to support the safe installation of grab rails at a later date			
<p>a. Except for walls constructed of solid masonry or concrete, the walls around the shower, bath (if provided) and toilet should be reinforced to provide a fixing surface for the safe installation of grab rails.</p> <p>Reference: Figure 54 Notes: See Att. 02 – Can be compliant at CC stage</p>	<input type="checkbox"/>	<input type="checkbox"/>	✓
<p>b. The fastenings, wall reinforcement and grab rails combined must be able to withstand 1100N of force applied in any position and in any direction.</p> <p>Notes: See Att. 02 – Can be compliant at CC stage</p>	<input type="checkbox"/>	<input type="checkbox"/>	✓
<p>c. The walls around the toilet are to be reinforced by installing:</p> <ul style="list-style-type: none"> I. noggings with a thickness of at least 25mm in accordance with Figure 6(a); or II. Sheeting with a thickness of at least 12mm in accordance with Figure 6(b). <p>Reference: Figure 53 Notes: See Att. 02 – Can be compliant at CC stage</p>	<input type="checkbox"/>	<input type="checkbox"/>	✓

d. The walls around the bath are to be reinforced by installing: noggings with a thickness of at least 25mm in accordance with Figure I. 7(a); or II. Sheeting with a thickness of at least 12mm in accordance with Figure 7(b).	<input type="checkbox"/>	<input checked="" type="checkbox"/>	<input type="checkbox"/>
e. The walls around the hobless (step-free) shower recess are to be reinforced by installing: I. noggings with a thickness of at least 25mm in accordance with Figure 8(a); or II. Sheeting with a thickness of at least 12mm in accordance with Figure 8(b). Reference: Figure 54 Notes: See Att. 02 – Can be compliant at CC stage	<input type="checkbox"/>	<input type="checkbox"/>	<input checked="" type="checkbox"/>
7. A continuous handrail on one side of any stairway where there is a rise of more than one metre.			
a. Stairways in dwellings must feature: I. A continuous handrail on one side of the stairway where there is a rise of more than 1m.	<input type="checkbox"/>	<input checked="" type="checkbox"/>	<input type="checkbox"/>



The references below are to be read as set and referenced in each section of the SEPP 65 Part 4Q1

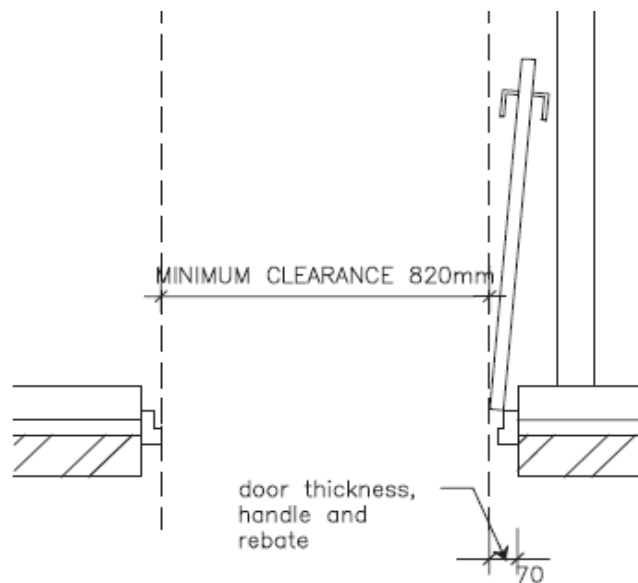

Figure 2(a) Silver level clear door opening

Figure 50

SAI Global Ltd License 1704-c045-2

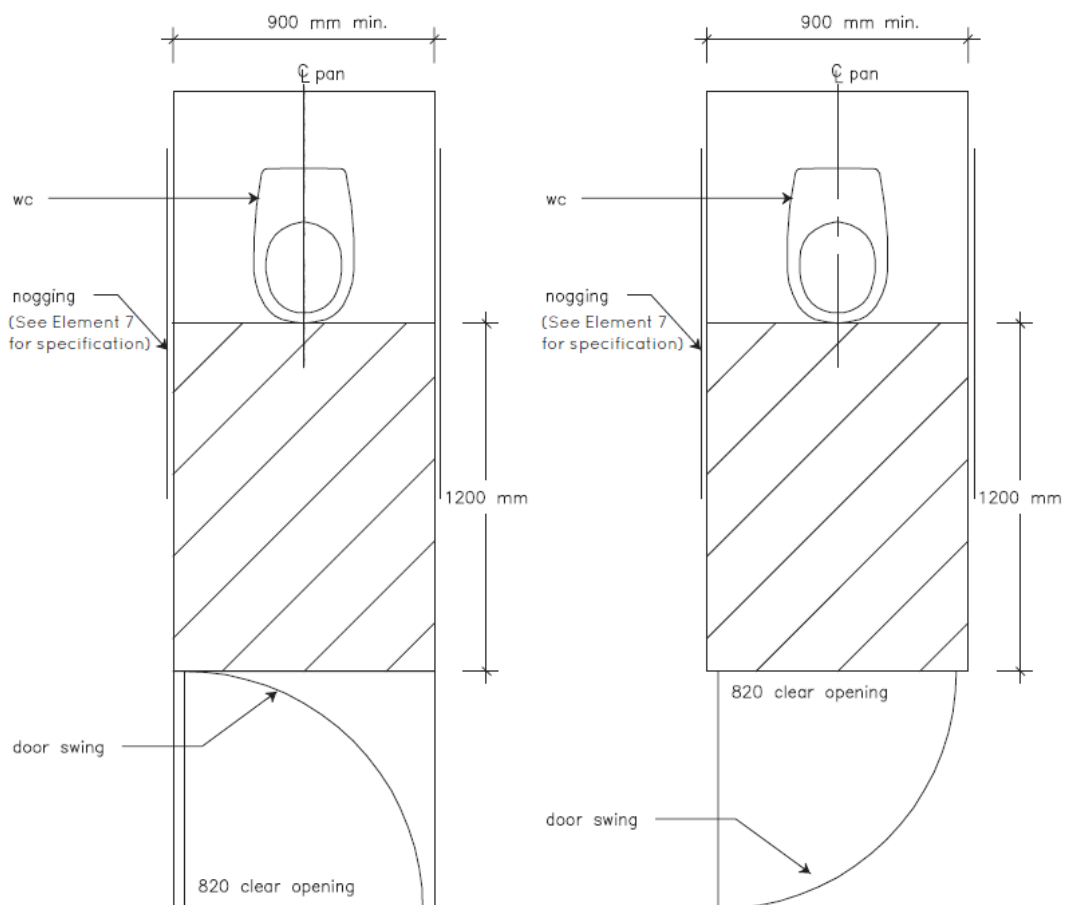

Figure 51

SAI Global Ltd License 1704-c045-2

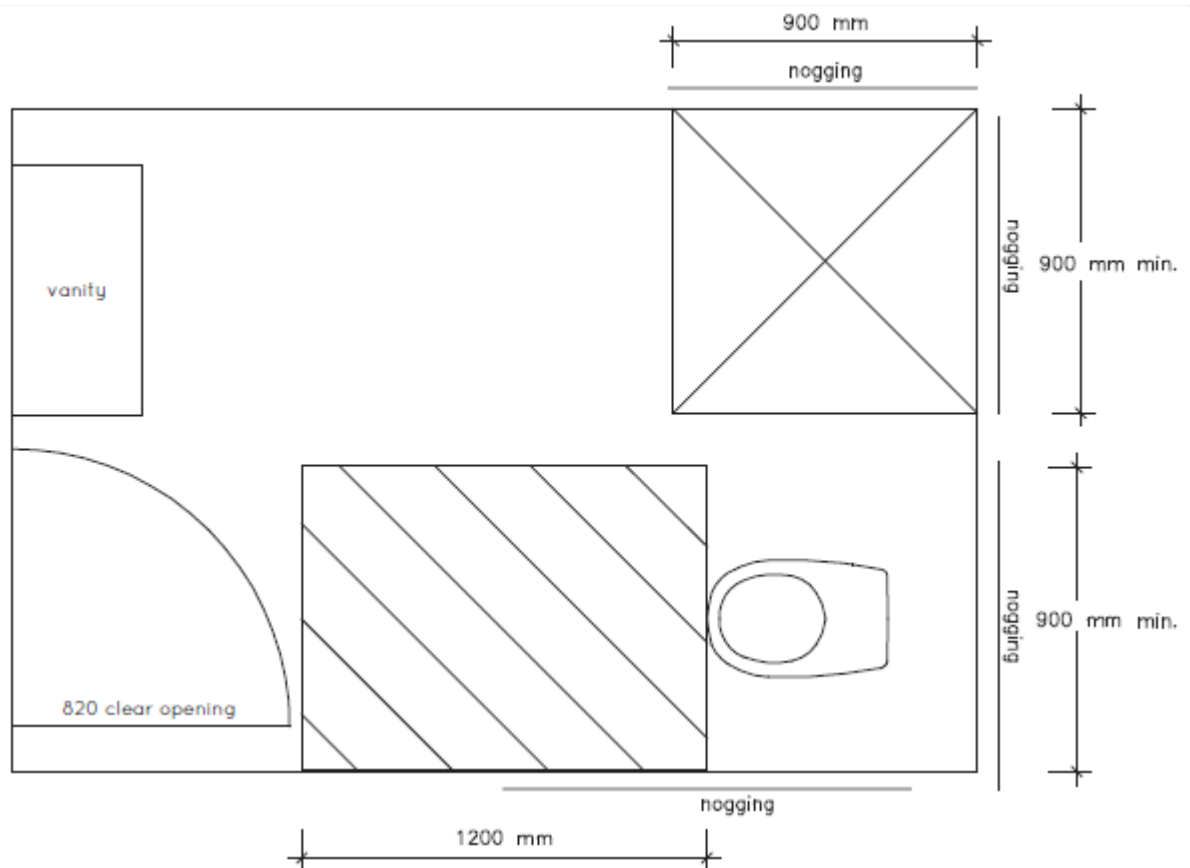

Figure 3(b) Silver level ground (or entry) level toilet layout and space requirements in a combined bathroom.

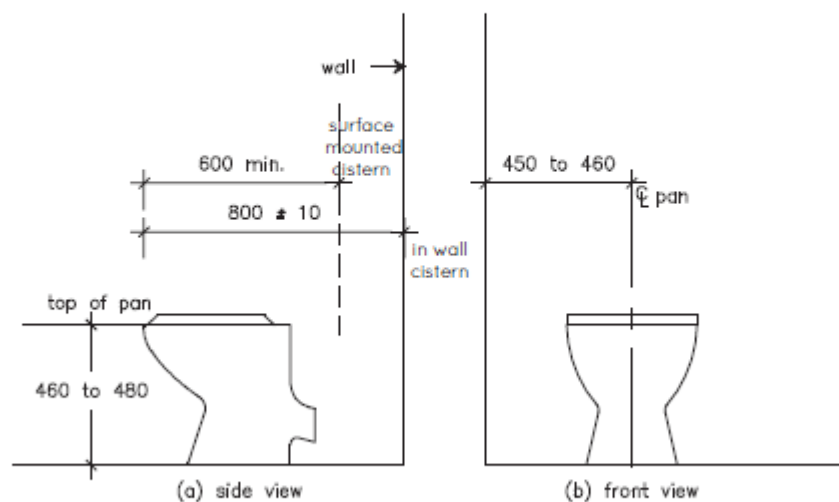

Figure 52

SAI Global Ltd License 1704-c045-2

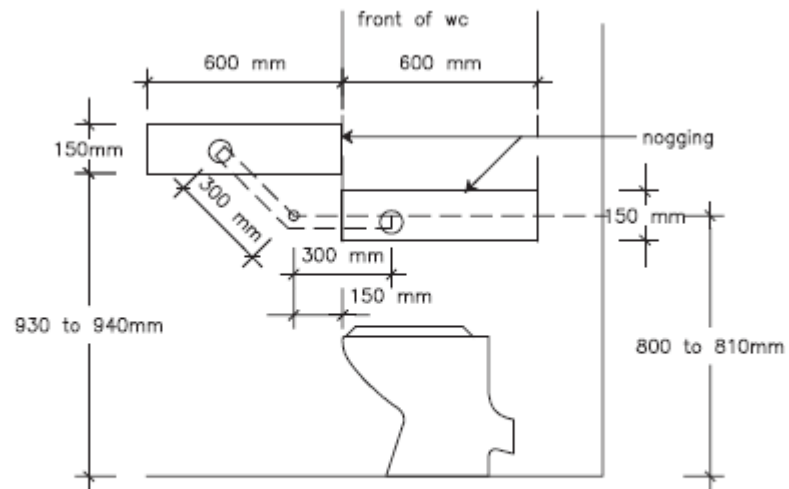

Figure 6(a) Toilet – Location of noggings

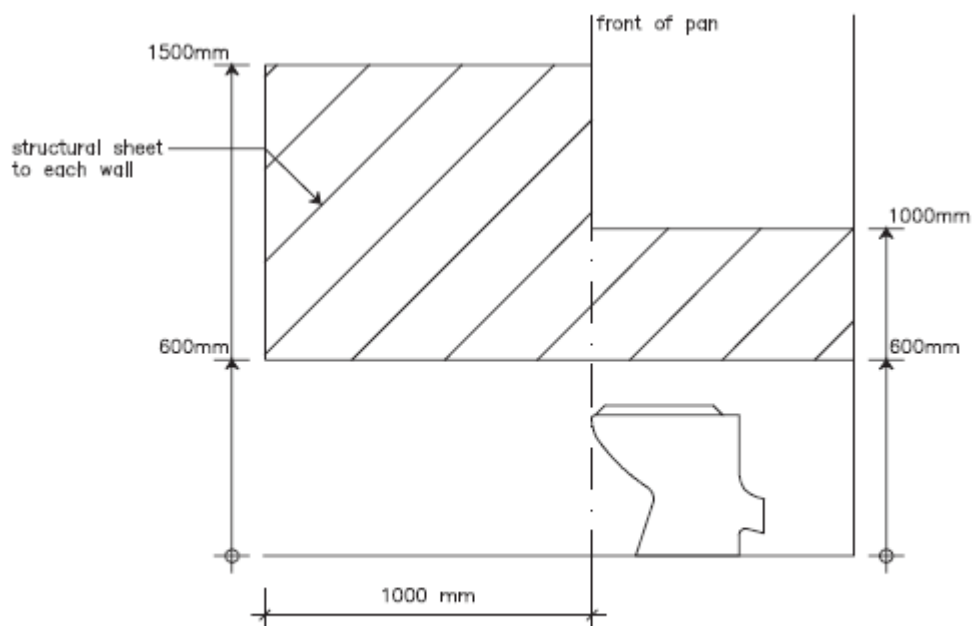

Figure 6(b) Toilet – Location of sheeting

Figure 53

SAI Global Ltd License 1704-c045-2

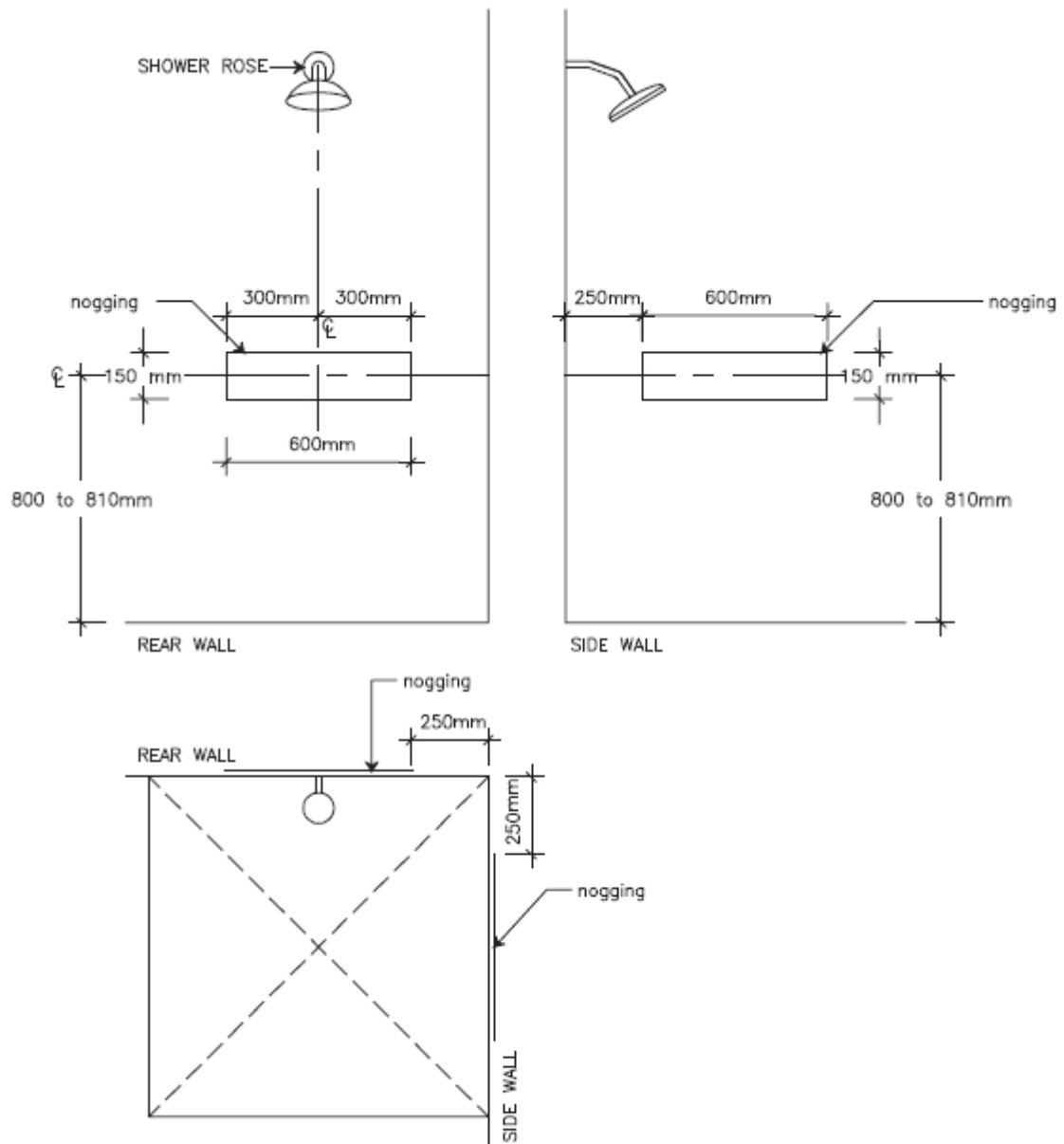

Figure 8(a) Shower recess – Location of noggings

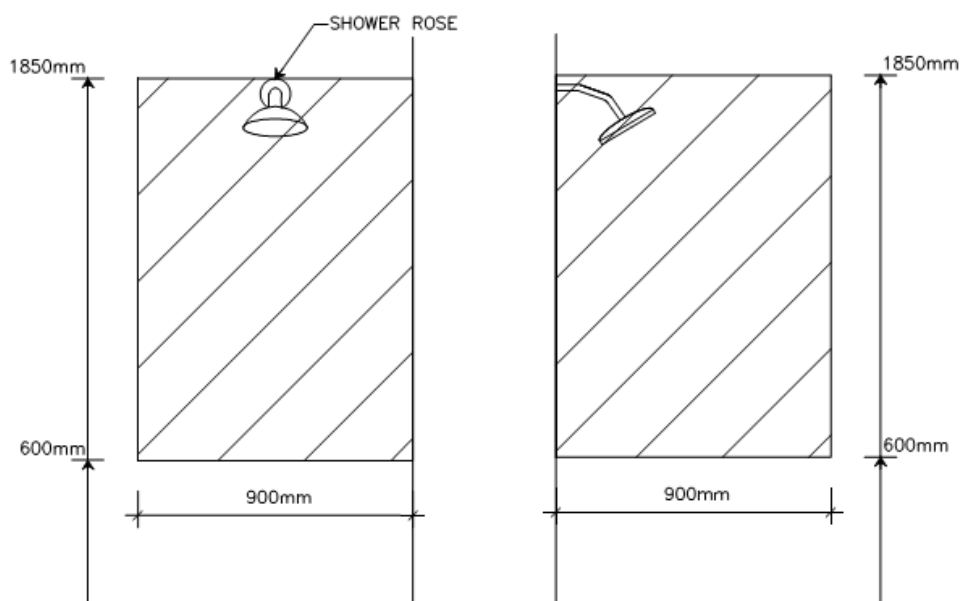
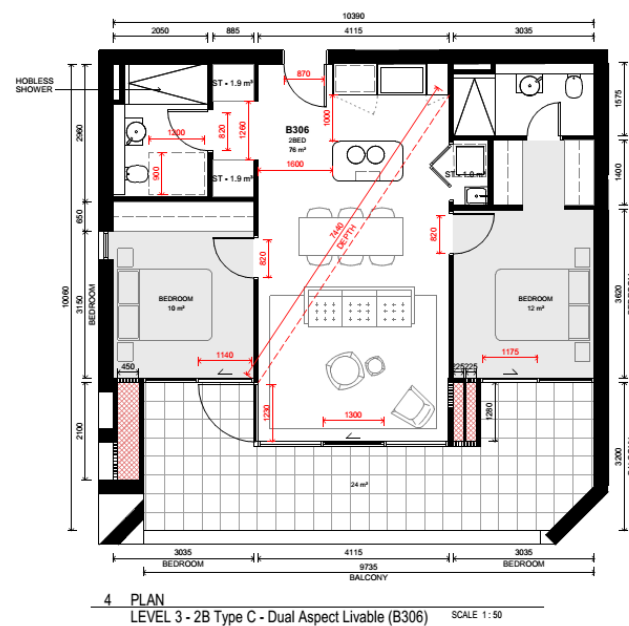
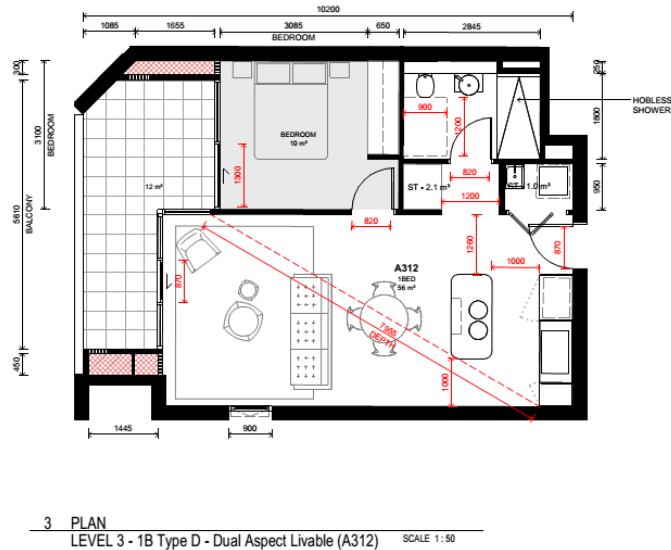
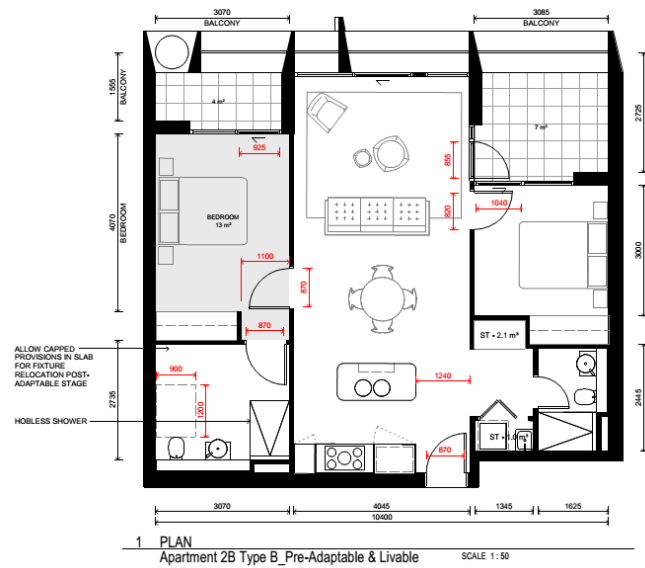

Figure 54

SAI Global Ltd License 1704-c045-2

The Livable units below are to be read in conjunction with each section of the SEPP 65 Part 4Q1



Att. 02 SJB Architects Livable Layouts Issue No. 4 dated 01/11/2022

Advisory Only

The Disability Discrimination Act (1992) (DDA) protects everyone in Australia against discrimination based on disability ranging from, but not limited to mobility, sensory and cognitive disabilities. There is no doubt that the introduction of the Premises Standards has led to widespread and important improvements in the accessibility world and safety of all new and upgraded public building in Australia.

Section 32 of the DDA makes it unlawful to contravene a provision of a disability standard & the persons responsible who fail to address the 'affected part' requirements when triggered for a building could be subject to complaint under the DDA as a result.

If there is a difference between the technical requirements of the Access Code and any document referenced in the Access Code, including Australian Standards, the Access Code takes precedence.

The basic trigger for the application of the Premises Standards is when any building work is undertaken that requires building/construction approval. A building certifier, building developer or building manager of a relevant building must ensure that the building complies with the Access to Premises Standards.

The scope of the DDA also includes the area of the room measured within the finished surfaces of the walls, and includes the area occupied by any cupboard or other built-in furniture, fixture, or fittings.

Scope of DDA extends beyond the building fabric and includes furniture and fittings. We cannot guarantee or certify for DDA compliance because DDA compliance can only be assessed by the court.

a: L10, 11-15 Deane St, Burwood NSW 2134

e: contact@accesslink.com.au

t: (02) 8319 4646

accesslink.com.au